

# SAMSUNG

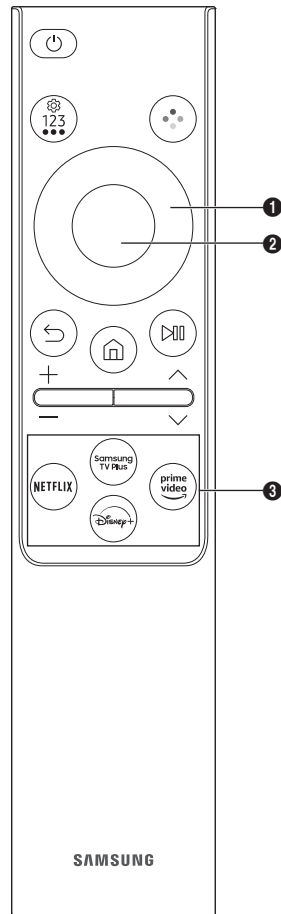

BN68-18454D-00

## About the Buttons on the Remote Control



Button	Description
(Power)	Press to turn the TV on or off.
(Settings / Number / Option button)	<p>You can access Setting menu / virtual numeric pad / Option pad / SmartThings directly.</p> <ul style="list-style-type: none"> <li>Accessing the SmartThings app using this button may not be supported, depending on the model.</li> <li>Use this button to access additional options that are specific to the feature in use.</li> <li>Press to bring up the virtual numeric pad on the screen. Use the numeric keypad to enter numeric values. Select numbers and then select <b>Done</b> or <b>Enter Number</b> to enter a numeric value. Use to change the channel, enter a PIN, ZIP code and etc.</li> <li>When pressed for 1 second or more, the <b>Shortcuts</b> menu screen appears.</li> </ul>
(Colour button)	When pressed, coloured buttons appear on the screen. Use this button to access additional options that are specific to the feature in use.
<b>1</b> Directional button (up, down, left, right)	Moves the focus and changes the values seen on the TV's menu.
<b>2</b> Select	Selects or runs a focused item. When pressed while you are watching a broadcast programme, detailed programme information appears.
(Return)	Press to return to the previous menu. When pressed for 1 second or more, the running function is terminated. When pressed while you are watching a programme, the previous channel appears.
(Smart Hub)	Press to switch to the Home Screen.
(Play/pause)	When pressed, the playback controls appear. Using these controls, you can control the media content that is playing.
+ / - (Volume)	Move the button up or down to adjust the volume. To mute the sound, press the button. When pressed for 2 seconds or more, the <b>Accessibility Shortcuts</b> appears.
^ / v (Channel)	<p>Move the button up or down to change the channel. To see the <b>Guide</b> screen, press the button.</p> <ul style="list-style-type: none"> <li>When pressed for 1 second or more, the <b>Channel List</b> screen appears.</li> </ul>
<b>3</b> Launch app button	<p>Press each button to run its function.</p> <ul style="list-style-type: none"> <li>Available apps may differ depending on the geographical area or contents provider.</li> </ul>

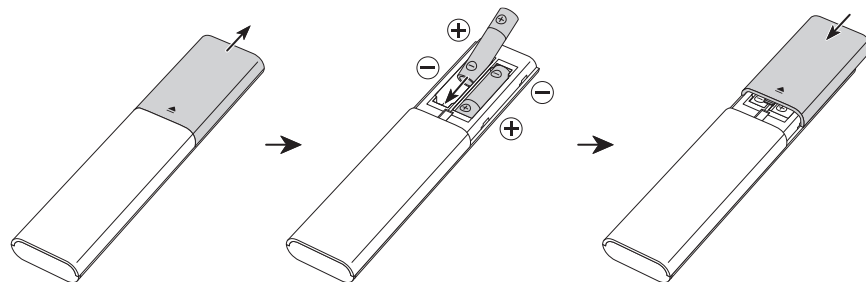

- The images, buttons, and functions of the remote control may differ with the model or geographical area.
- If you use the remote control that comes with your TV to control another TV, some functions may not operate normally.

# SAMSUNG

## About the Buttons on the Standard Remote Control

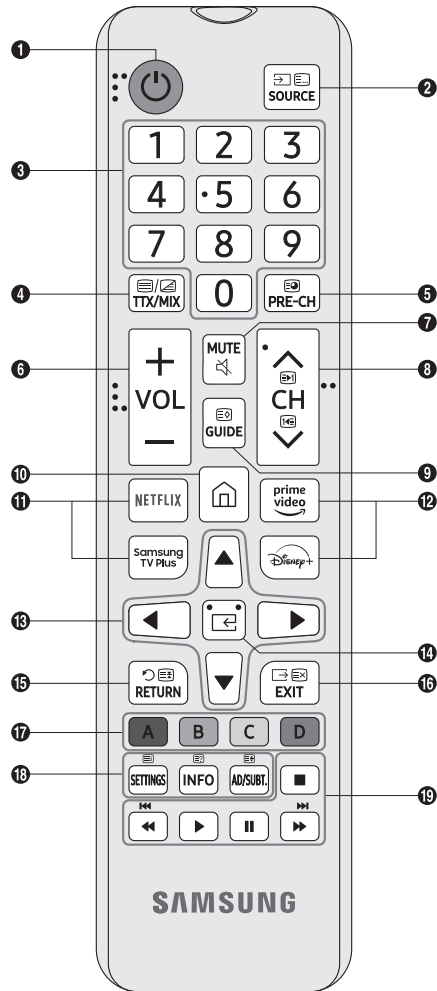

Number	Description
1	⏻ (Power) Turns the TV on and off.
2	Displays and selects available video sources.
3	Gives direct access to channels.
4	Alternately selects Teletext mode, Full TTX / Double TTX / Mix / Live TV.
5	Returns to the previous channel.
6	Adjusts the volume.
7	Turns the sound on/off.
8	Changes the current channel.
9	Displays the Guide screen.
10	Press to switch to the Home Screen.
11, 12	Press each button to run its function. • Available apps may differ depending on the geographical area or contents provider.
13	Moves the cursor, selects the on-screen menu items, and changes the values seen on the TV's menu.
14	⏏ (Select) Selects or runs a focused item.
15	Returns to the previous menu or channel.
16	Exits the menu.
17	Use these buttons according to the directions on the TV screen.
18	<b>SETTINGS</b> Displays the main on-screen menu. <b>INFO</b> Displays information about the current programme or content. <b>AD/SUBT.</b> Displays the Accessibility Shortcuts.
19	Use these buttons with specific features. Use these buttons according to the directions on the TV screen.

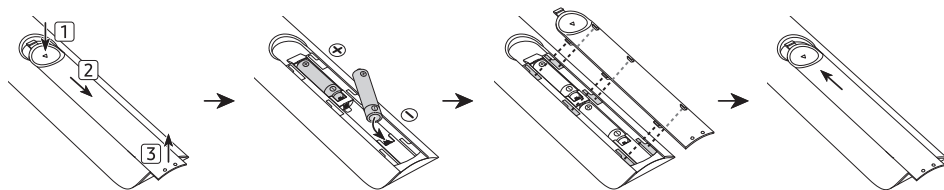

- The images, buttons, and functions of the remote control may differ depending on the model.
- This remote control has Braille points on the Power, Channel, Volume, and Select buttons and can be used by visually impaired persons.
- If you use the remote control that comes with your TV to control another TV, some functions may not operate normally.