

MAJORITY

K2

BLUETOOTH SOUNDBAR

K 2 - B A R - B L K



EN

Instructions Guide

Controls And Functions.....	1
What's In The Box?.....	4
Wall Mounting and Auto-Power Off	5
Instructions Guide.....	6
Using the RCA Audio Cable.....	6
Using the ARC Input	7
Using the Optical Input	8
Using the MP3 LINK Connection (Line In).....	9
Connecting to the Mains Supply.....	10
Connecting the Soundbar and Sub-woofer.....	11
Bluetooth Operation	12
FM Mode.....	13
Troubleshooting	14
Specification.....	15
Warranty	15
Safety Information	16

3

**YEAR
WARRANTY**

Register your product online for a **FREE 3 year**
extended warranty at: www.majority.co.uk

Side View + Back View

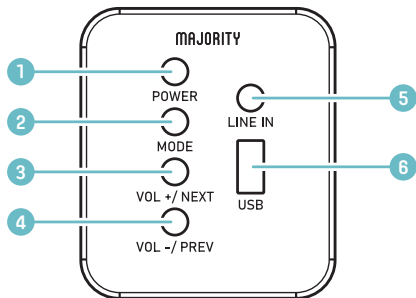

- | | |
|-------------------|---------------------|
| 1. Power | 4. Volume-/Previous |
| 2. Mode | 5. Line In |
| 3. Volume +/-Next | 6. USB Function |

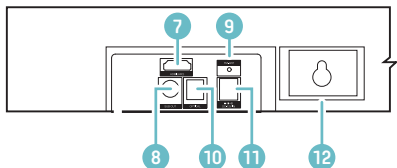

- | | |
|---------------------|--------------------|
| 7. HDMI ARC Input | 10. Optical Input |
| 8. Subwoofer Output | 11. DC Power Input |
| 9. FM Antenna | 12. Wall Bracket |

Remote Control

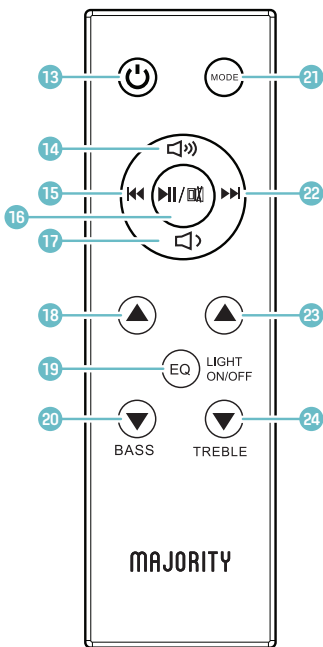

13. Power On/Off

14. Volume +

15. **Back step:** Use in AUX or Bluetooth mode to go back a track.

16. Play/Pause

17. Volume -

18. Bass increase

19. **EQ:** Press the button to adjust the equaliser. Press and **hold** the button to turn the soundbar LED light on and off. EQ settings can be changed in any play mode.

20. Bass decrease

21. **Mode:** Switch between modes

22. **Forward step:** Use in AUX or Bluetooth mode to go forward a track

23. Treble increase

24. Treble decrease

Subwoofer

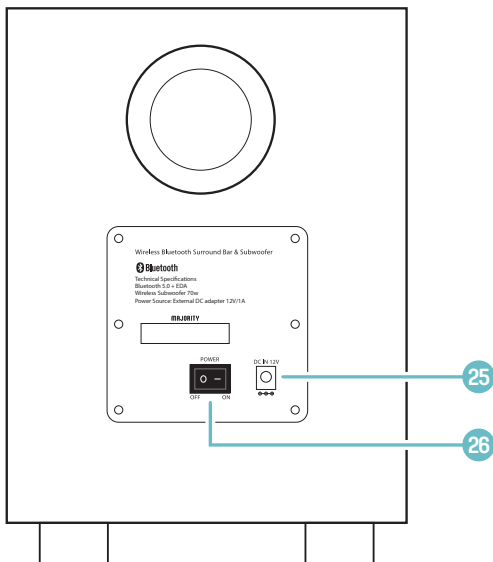

- 25. DC adapter input
- 26. Power Switch

Box Contents

27. Majority K2 Soundbar

28. Subwoofer

29. Remote Control

30. 3.5mm to 3.5mm Audio Cable

31. RCA Cable

32. HDMI Cable

33. Power Adapter x 2

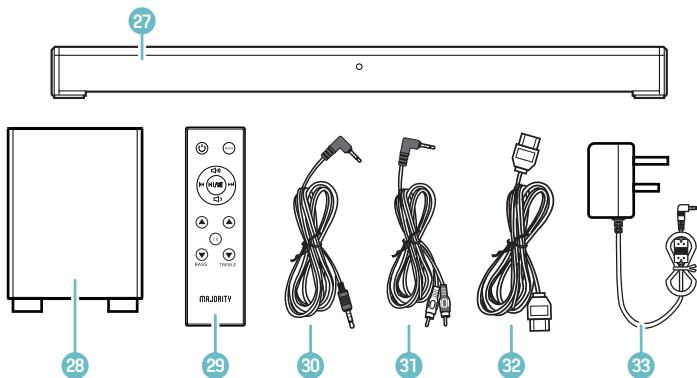

Wall Mounting and Auto-Power Off

Wall Mounting

The Majority K2 can be mounted to a wall using the appropriate fittings for your wall type by using the wall mounting brackets positioned at the rear of the unit. As these differ between wall types the fittings are not included. To wall mount the K2 soundbar, the appropriate fittings for your application will need to be sourced.

Auto power off function

Automatic Power Off Mode

The Majority K2 Soundbar will automatically go into sleep mode after 180 minutes if the TV is off.

Using the RCA Audio Cable

Connect the RCA Stereo Audio Cable to connect the TV's stereo RCA (L/R) audio output socket.

Connect the audio output cable to the side of the soundbar via the 'LINE IN' input sockets (**Ref.5**).

Then press MODE on the remote control (**Ref.21**) or on the unit (**Ref.2**) to select LINE mode.

Troubleshooting: If you are not receiving a picture, please ensure that the RCA cable is connected to 'output' RCA ports on your TV.

If your TV does not have 'output' RCA ports, please use an alternative connection method.

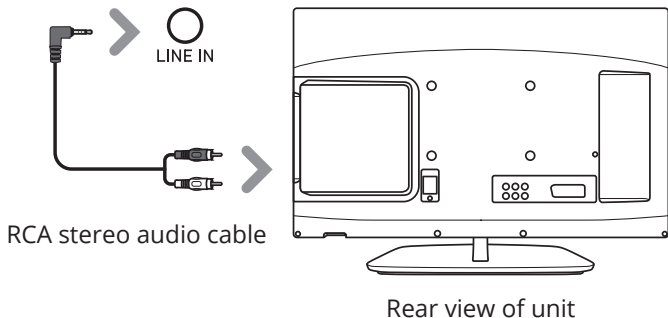

Using the ARC Input

You will need: an audio source with an ARC audio output and an HDMI ARC cable (included).

Connect the ARC audio cable from the ARC input on the soundbar (**Ref.7**) to the ARC output on your audio source.

Switch on the soundbar.

Press the MODE button on the remote control (**Ref.21**) or on the unit (**Ref.2**) until ARC mode is selected.

Using the native controls on your connected device, ensure the audio settings are set to ARC or HDMI Audio.

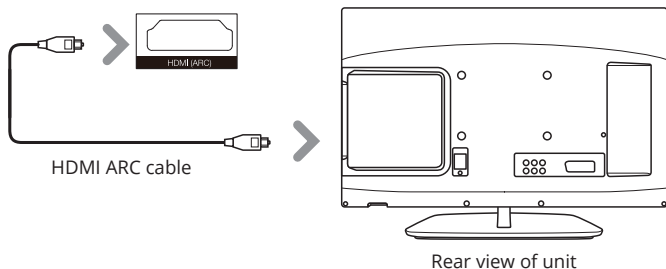

Using the Optical Input

You will need: An audio source with an Optical Audio Output and a Digital Optical Audio cable (not included).

Connect the Optical cable from the soundbar (**Ref.10**) to your audio source.

Switch on the soundbar. Press the MODE button on the remote control (**Ref.21**) or on the unit (**Ref.2**) until OPTICAL mode is selected.

How do I set the correct Audio settings for Optical mode?

When using the soundbar in Optical mode, or when using the soundbar with an App such as Netflix or Amazon Prime, you may experience sound issues if you have your audio settings set up incorrectly. Using the native controls on your connected device, make sure the audio settings are set to PCM or Optical Audio.

This setting can be found within your TV's sound settings, most likely under 'Additional Settings' within the Sound menu, where you will find options for 'PCM/Dolby Digital/DTS/DTS Neo 2:5'.

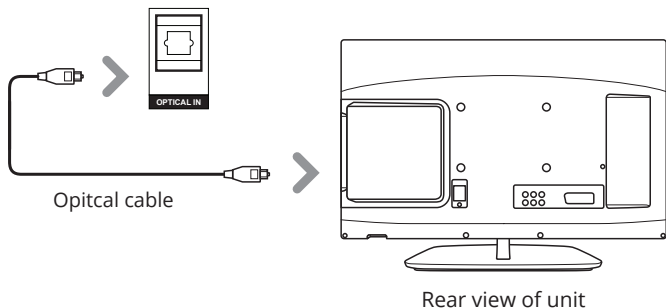

Using the MP3 LINK Connection (Line In)

Plug one end of a 3.5mm audio input cable (included) into the Line In input on the unit (**Ref.5**). Before use, disconnect any cables connected to the Stereo RCA Inputs.

Plug the other end of the cable into the audio output/headphone output on your audio source.

Switch on the soundbar.

Press the Mode button repeatedly on the soundbar (**Ref.2**) or on the remote control (**Ref.21**) until LINE in mode is selected.

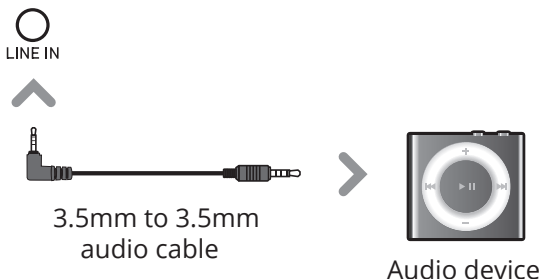

Connecting to the Mains Supply

Ensure that the power supply voltage is within the range of 100V~240V. Any other voltage may cause damage to the unit.

Unwind the mains cable to its full length. Connect the mains plug to a mains socket. Make sure the mains plug is fully inserted into the mains socket.

Connect the adapter to the unit via the DC input Socket (**Ref.11**).

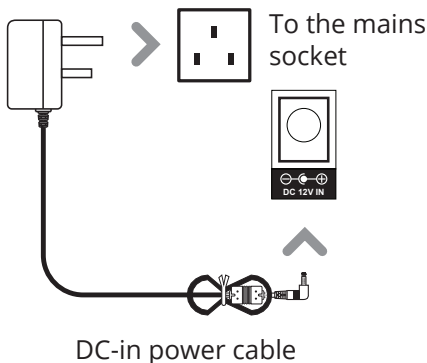

Ensure all audio connections of the unit are connected before connecting to the mains power socket. Unplug the power cord from the outlet when the unit is use for an extended period of time.

Connecting the Soundbar and Subwoofer

Please note: The soundbar and subwoofer must be within a 10 metre range of each other in order to be successfully connected.

The sub-woofer and soundbar will wirelessly connect to each other for a surround sound experience. This allows you to place the sub-woofer within the corner of the room to ensure that the sound from your TV fills the room.

To connect them together, please ensure that your soundbar is being mains powered and switched 'ON' for initial set up. To do this, press the Power button (**Ref.1**) on the unit or the POWER button on the remote control (**Ref.13**).

Follow by plugging the subwoofer into a power source, and turning it ON via the power switch (**Ref.26**)

The sub-woofer and soundbar should then automatically connect via wireless Bluetooth connectivity.

If you are having connectivity issues, please move the sub-woofer closer to the soundbar for set up.

Bluetooth Operation

Pairing a Bluetooth Device for the First Time

Press the POWER button on the unit (**Ref.1**) or the POWER button on the remote control (**Ref.13**) to switch on the unit.

Select and press the MODE button repeatedly on the remote control until in Bluetooth mode (**Ref.21**) or press the Mode button (**Ref.2**) repeatedly on the soundbar to enter Bluetooth mode.

Using the native controls on your Bluetooth device, select the “Majority Ben Nevis II+” in your Bluetooth settings to pair.

If your device requests a password, enter the default “0000”. Refer to the user manual for your specific device for instructions on pairing and connecting Bluetooth devices.

When successfully paired and connected, a beep will issue from the unit. After initial pairing, the unit will stay paired unless unpaired manually by the user.

If your device should become unpaired or you find it is unable to connect, repeat the above steps.

FM Mode

Press the MODE button on the remote control (**Ref.21**) or on the soundbar (**Ref.2**) until FM mode is selected.

Ensure that the wire aerial on the back panel of the soundbar is extended.

In FM mode, press and **hold** the 'Play/Pause' button on the remote (**Ref.16**) to begin searching for available FM stations.

After the search is complete, the soundbar will save the stations with good signal. To scroll through these saved stations, use the 'Previous/Next' buttons on the remote control (**Ref.15/Ref.22**).

Please note:

If you are having trouble with receiving stations, complete another auto-scan and adjust the aerial if required.

Troubleshooting

If you encounter an issue with your soundbar, please refer to the following checklist.

Observation	Potential Cause/Solution
No power/function	Check that the power is switched on at the wall. Check that the power adaptor is properly connected to the power outlet.
No sound	Check that cables are properly installed. If they are, please try connecting to your TV using an alternative cable. Check unit is switched on and in correct mode.
No sound in Bluetooth mode	Check that your Bluetooth device is paired. Check whether external device requires password "0000" to start with.
Function disturbance	Switch off and unplug the unit. Leave for 2 minutes and switch on again. If a particular mode is causing problems, please try an alternative connection to your TV such as Optical or Bluetooth.
Remote control function issues	Check whether the battery needs replacing, and replace if necessary. Check whether there are obstacles blocking the remote sensor.
Sound issues - buzzing when using Optical Mode, Netflix or Amazon Prime	Ensure that the audio settings on your TV are set to 'PCM'. See page 8 for details.

Specification

Power Supply	DC 12V/1A
Power Consumption	75W
Power Output (max)	75W*2 + 75W Subwoofer
Frequency Response	+/- 3dB
Bluetooth	V3.0
Dimension (WxHxD)	76.2 x 5.3 x 6.9 cm sound bar 28 x 19.7 x 19.7 cm sub woofer

Support

If you require further assistance with your new soundbar, please contact our support team on the Majority website:

www.majority.co.uk/support

Warranty

All products come with a standard 12 month warranty. All items must be registered on www.majority.co.uk for the warranty to be valid. Once on the web page, use the menu to find "Register Your Product". You will also be given the chance to extend your warranty for an additional 24 months, free of charge.

1. Read these instructions.
2. Keep these instructions. Instructions are also available for download at www.majorityradios.co.uk
3. Heed all warnings
4. Follow all instructions
5. Do not clean the apparatus near or with water
6. Do not block any ventilation openings. Install in accordance with the manufacturer's instructions
7. Do not install near any heat sources such as radiators, heat registers, stoves, or other apparatus (including amplifiers) that produce heat.
8. Protect the power from being walked on or pinched particularly at plugs, convenience receptacles, and the point where they exit from the apparatus.
9. Only use attachments/accessories specified by the manufacturer.
10. Unplug this apparatus during light storms or when unused for long periods of time.
11. Refer all servicing to qualified service personnel.
Servicing is required when the apparatus has been damaged in a way, such as power-supply cord or plug is damaged, liquid has been spilled or objects have fallen into the apparatus, the apparatus has been exposed to the rain or moisture, does not operate normally or has been dropped.
12. No naked flame sources, such as lit candles, should be placed on the apparatus.
13. Dispose of used electrical products and batteries safely according to your local authority and regulations.

ADDITIONAL WARNINGS

The apparatus shall not be exposed to dripping or splashing and no objects filled with liquid, such as vases, shall be placed on the apparatus. Main plug is used to disconnect device and it should remain readily operable during intended use. In order to disconnect the apparatus from the main mains completely, the mains plug should be disconnected from the main socket outlet completely. Battery shall not be exposed to excessive heat such as sunshine, fire or the like.



RECYCLING ELECTRICAL PRODUCTS

You should now recycle your waste electrical goods and in doing so help the environment.

 This symbol means an electrical product should not be disposed of with normal household waste. Please ensure it is taken to a suitable facility for disposal when finished with.



IMPORTANT: Please read all instructions carefully before use and keep for future reference.



Risk of electric shock.
Do not open



Read all instructions carefully before use and keep for future reference

When servicing, use only identical replacement parts



CAUTION

RISK OF ELECTRIC SHOCK
DO NOT OPEN



ATTENTION

RISQUE D'ELECTROCUTION
NE PAS OUVRIR



IMPORTANT: Please read all instructions carefully before use and keep for future reference

MAJORITY

www.majority.co.uk