

# SHURE®

LEGENDARY  
PERFORMANCE™

## SOUND ISOLATING™ EARPHONES

### SE846 Internal Component View

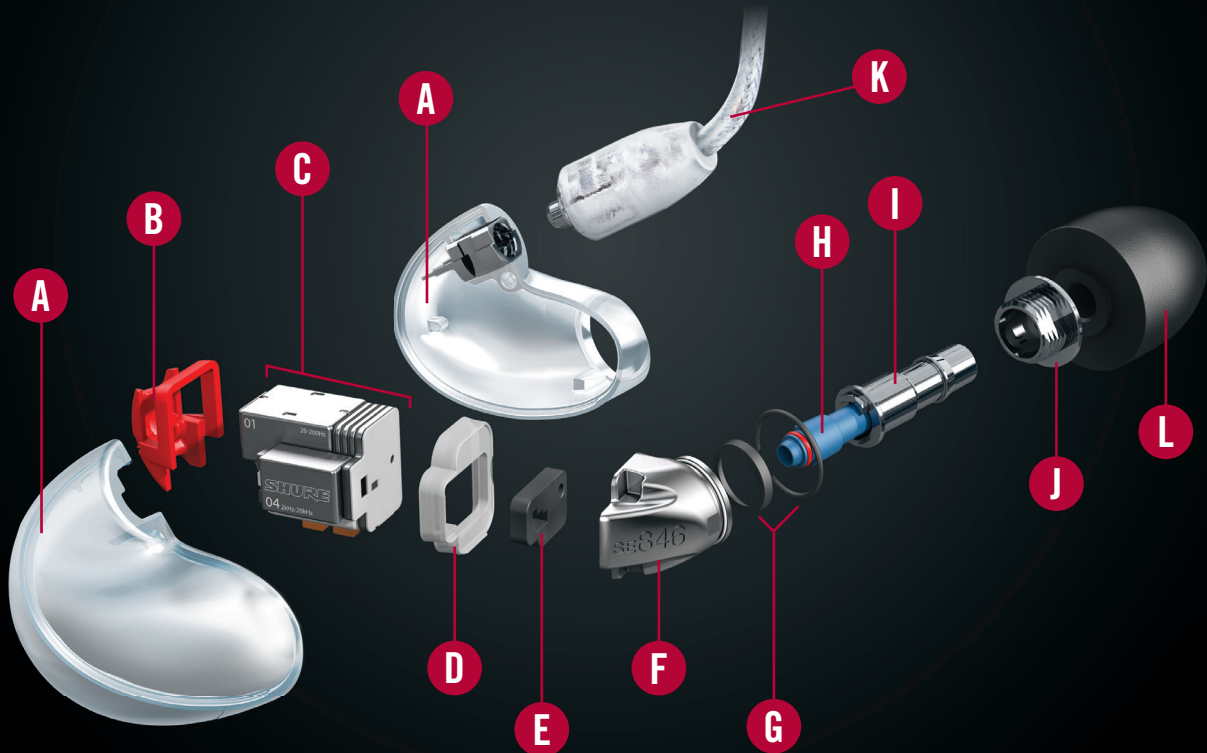

## SE846 COMPONENTS

- A Rugged Ergonomic Housing**  
The low-profile design features durable, sweat-resistant construction, built to fit comfortably in the ear and withstand the extremes of on-stage or everyday wear.
- B Driver Carrier**  
Indicates right (red) or left side (clear) and securely holds the driver unit in place.
- C Driver Assembly Unit**  
Precision engineered component composed of four High-Definition MicroDrivers (dedicated high, mid, and dual low frequency speakers) and ground breaking low-pass Filter design. Acts as the earphone's engine to deliver true subwoofer performance with extended high-end clarity.
- D Shock Isolator**  
Shock protector that guards the MicroDrivers against sudden impact.
- E Driver Acoustic Seal**  
Maintains the integrity of the acoustic system while efficiently directing audio to the nozzle.
- F Nozzle Interface**  
Laser etched with the SE846 model number, the nozzle interface joins the acoustic and nozzle seals to the stainless nozzle, efficiently directing the sound to the nozzle.
- G Nozzle Interface Seals**  
Comprised of two seals that securely integrate the nozzle interface with the stainless nozzle. One is designed for environmental protection against moisture/perspiration, and the other for acoustics.
- H Nozzle Insert**  
Removable filtered tube that sits inside the stainless nozzle. Three options included provide the option to change the sound signature with a shift of about 3-5 dB in the 1 kHz – 8 kHz range.
- I Stainless Steel Nozzle**  
Specially angled metal tube ensures efficient audio delivery and ergonomic fit. Removable for easy cleaning or replacement for customizing frequency response.
- J Stainless Steel Threaded Collar**  
Removable to allow for stainless nozzle replacement and cleaning. Ensures snug/correct fit of the nozzle and nozzle inserts into the nozzle interface unit.
- K Detachable Cable**  
Wireform fit ensures secure placement, detachability for easy replacement or customization, and Kevlar™ reinforced for durability. Worn over the ear.
- L Sound Isolating™ Sleeve**  
selection of foam and flex sleeves create a customized fit and comfortable seal that blocks background noise.

# SHURE®

LEGENDARY  
PERFORMANCE™

## SOUND ISOLATING™ EARPHONES

### SE846 Internal Component View

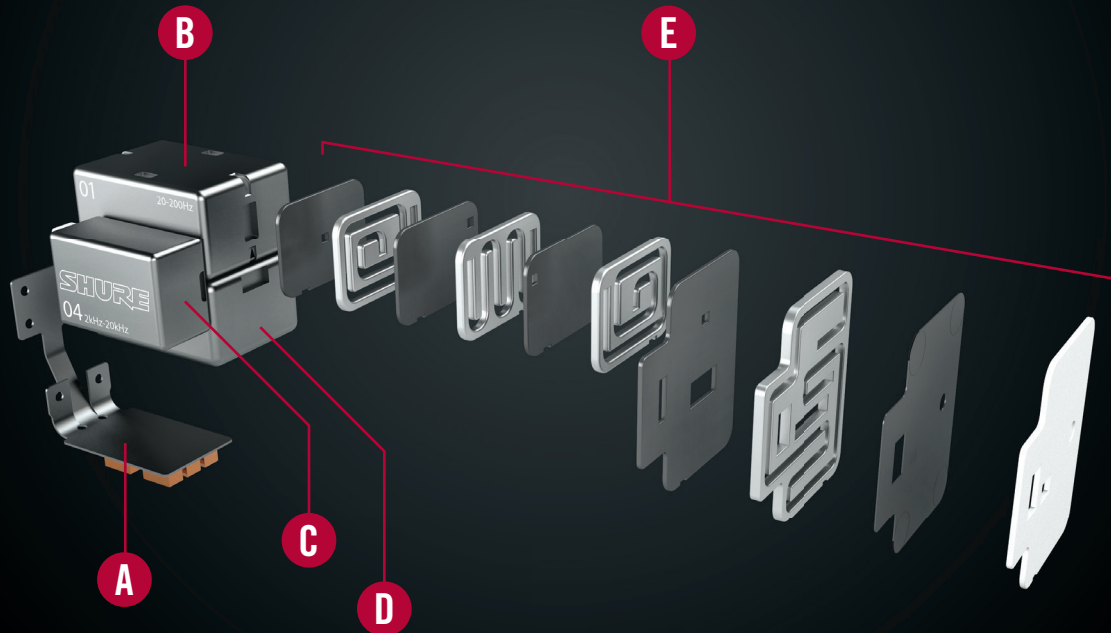

## SE846 DRIVER ASSEMBLY INSET

- A Internal Three-Way Crossover**  
Capacitors and resistors built to route specific frequencies to the appropriate MicroDrivers ensuring clarity across the audio spectrum.
- B Dual Vented Low Frequency MicroDrivers (01 + 02)**  
Audio signal from these dual MicroDrivers travels through the low-pass filter, allowing low frequency roll-off to begin at 75Hz without introducing distortion and providing true subwoofer performance with deep, accurate bass.
- C High Frequency MicroDriver (04)**  
Designed for extended high-end clarity and low distortion.
- D Mid Frequency MicroDriver (03)**  
Custom-engineered to blend with the low and high frequency drivers. The audio signal is routed through a special microscopic electroform damper fabricated into one of the stainless steel plates in the low-pass filter design, avoiding comb filtering at the crossover regions and providing a smooth, clean presence.
- E Low-Pass Filter**  
Composed of ten small stainless-steel plates laser welded to the front of the driver assembly unit, the ground breaking design forms 4 inches of high acoustic mass path which naturally allows for low frequency roll-off to begin at about 75Hz without distortion or artifacts.