

Owner's Manual

SCREAM BASS

Overdrive For Bass Guitar

Bass Series

NUX

www.nuxefx.com

Copyright

Copyright 2015 Cherub Technology Co. All rights reserved. NUX and SCREAM BASS are trademarks of Cherub Technology Co. Other product names modeled in this product are trademarks of their respective companies that do not endorse and are not associated or affiliated with Cherub Technology Co.

Accuracy

Whilst every effort has been made to ensure the accuracy and content of this manual, Cherub Technology Co. makes no representations or warranties regarding the contents.

WARNING!-IMPORTANT SAFETY INSTRUCTIONS BEFORE CONNECTING, READ INSTRUCTIONS

WARNING: To reduce the risk of fire or electric shock, do not expose this appliance to rain or moisture.

CAUTION: To reduce the risk of fire or electric shock, do not remove screws. No user-serviceable parts inside. Refer servicing to qualified service personnel.

CAUTION: This equipment has been tested and found to comply with the limits for a Class B digital device pursuant to Part 15 of FCC Rules. Operation is subject to the following two conditions: (1) This device may not cause harmful interference, and (2) this device must accept any interference received, including interference that may cause undesired operation.



The lightning symbol within a triangle means "electrical caution!" It indicates the presence of information about operating voltage and potential risks of electrical shock.



The exclamation point within a triangle means "caution!" Please read the information next to all caution signs.

- Use only the supplied power supply or power cord. If you are not sure of the type of power available, consult your dealer or local power company.
- Do not place near heat sources, such as radiators, heat registers, or appliances which produce heat.
- Guard against objects or liquids entering the enclosure.
- Do not attempt to service this product yourself, as opening or removing covers may expose you to dangerous voltage points or other risks. Refer all servicing to qualified service personnel.
- Refer all servicing to qualified service personnel. Servicing is required when the apparatus has been damaged in any way, such as when the power supply cord or plug is damaged, liquid has been spilled or objects have fallen into the apparatus, the apparatus has been exposed to rain or moisture, does not operate normally or has been dropped.
- The power supply cord should be unplugged when the unit is to be unused for long periods of time.
- Protect the power cord from being walked on or pinched particularly at plugs, convenience receptacles and at the point where they exit from the apparatus.
- Prolonged listening at high volume levels may cause irreparable hearing loss and/or damage. Always be sure to practice "safe listening".

Follow all instructions and heed all warnings
KEEP THESE INSTRUCTIONS!

Thank you for selecting the NUX products!

NUX Scream Bass is an analogue overdrive pedal designed for bass guitar. It has a wide tonal range from mild overdrive to fuzz. The Blend knob lets you set the balance between dry signal and overdrive signal. The Scream Bass is ideal for Punk, Rock, Thrash and Metal!

Product Description

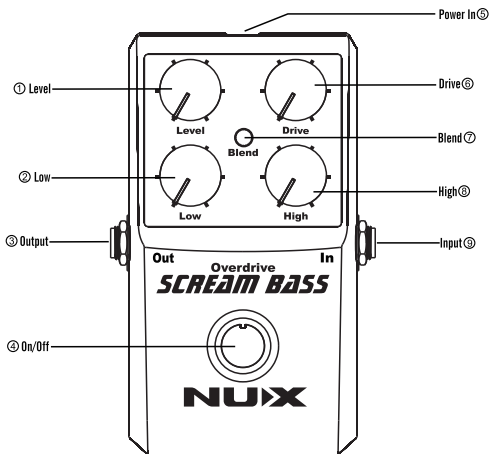

Features

- Analogue Circuit
- Wide Tonal Range from Overdrive to Fuzz
- 2-Band Equalizer: Low, High
- Blend Dry and Overdrive Signal
- True-Bypass
- Powered by 9V Battery or Optional Adaptor

Connection

Power In

Connect a 9V (negative tip) adapter. Optional NUX ACD-008A is recommended.

NOTE: Using other adapter may cause damage or noise.

Input

This is the input jack for plugging the guitar or the output of another pedal.

Output

This outputs the effect to a guitar amplifier or the input of another pedal.

Using Effects

Level Knob

Set the output level of the Scream Bass pedal.

Drive Knob

Set the overdrive amount.

Low Knob

Set the bass frequency.

High Knob

Set the treble frequency.

Blend Knob

Set the balance of the dry signal and overdrive signal to the Output when the effect is On. Turn it all the way down will only have the dry signal (without any overdrive effect); Turn it all the way up will only have the effected signal.

- Start by setting the Drive, Low, High, Blend knobs to the middle position, and increase the Level gradually from zero until you get proper volume.
- Adjust the Gain, Bass, and Treble to find the tone you like.
- Use the Blend knob to balance the dry signal and the overdrive signal to the Output.

About Battery

A 9V battery is included in the package in purpose of testing. If it is powered by battery, change a new battery when the LED goes dim. To save battery life, unplug the cable from the In jack when it is not in use. A high quality pedal power adaptor (optional NUX ACD-008A) is strongly recommended.

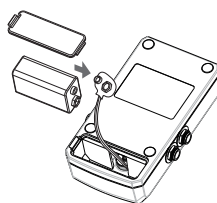

Troubleshooting

Unable to Turn On

- Check if the adapter is connected correctly and securely.
- If it is powered by battery, try a fresh battery.
- Check if the In jack is plugged in.

No Sound

- Try to plug the instrument directly into this pedal and output this pedal directly to the amp, and make sure the volume of the instrument and the amplifier is turned on.
- Check if all the cable connections are good and secure.

Noise Problem

- Make sure the power adaptor is with correct specifications (DC 9V, minimum 300mA, \ominus - \oplus - \ominus). We strongly recommend the NUX ACD-008A adaptor. Using other adapter may cause noise or malfunction.
- Setting the Drive too high will generate more noise. Try to lower down the Drive. Using guitar with single coil pickups may have more noise.

Poor Sound Quality

- Make sure all the cables are securely plugged into the pedal, guitar and the playback device, i.e. amplifiers.
- Make sure the power adaptor is with the correct specifications (DC 9V, minimum 300mA, \ominus - \oplus - \ominus). If it is powered by battery, try a new battery. For longest battery life, we suggest new, high quality ALKALINE battery.

Specifications

- Inputs: In (1/4" jacks)
- Outputs: Out (1/4" jacks)
- Input Impedance: 1M Ω
- Nominal Input Level: -20 dBu
- Nominal Output Level: -20 dBu
- Output Impedance: 1 K Ω
- Equivalent Input Noise Level: -110 dBu (HF-A, Typ.)
- Power Consumption: < 11mA
- Power Supply: 9V Battery, or AC adaptor to the DC 9V, \ominus - \oplus - \ominus (optional NUX ACD-008A)
- Dimensions: 122mm (L) x 72mm (W) x 47mm (H)
- Weight: 270g

*Specification may change without notice.

Precautions

Environment:

1. Do NOT use the scream bass in high temperature, or high humidity, or subzero environments.
 2. Do NOT use the scream bass in the direct sunlight.
- Please do NOT disassemble the scream bass by yourself.
 - Please keep this manual for future reference.

Accessories

- One 9V battery (only for testing purpose)
- Owner's manual

THE FCC REGULATION WARNING (for U.S.A.)

This equipment has been tested and found to comply with the limits for a Class B digital device, pursuant to Part 15 of the FCC Rules. These limits are designed to provide reasonable protection against harmful interference in a residential installation. This equipment generates, uses, and can radiate radio frequency energy and, if not installed and used in accordance with the instructions, may cause harmful interference to radio communications. However, there is no guarantee that interference will not occur in a particular installation. If this equipment does cause harmful interference to radio or television reception, which can be determined by turning the equipment off and on, the user is encouraged to try to correct the interference by one or more of the following measures:

- Reorient or relocate the receiving antenna.
- Increase the separation between the equipment and receiver.
- Connect the equipment into an outlet on a circuit different from that to which the receiver is connected.
- Consult the dealer or an experienced radio/TV technician for help.

CE mark for European Harmonized Standards

CE Mark which is attached to our company's products of Battery mains the product is in fully conformity with the harmonized standard(s) EN 61000-6-3:2007+A1:2011 & EN 61000-6-1:2007 Under the Council Directive 2004/108/ EC on Electromagnetic Compatibility.

©2015 Cherub Technology-All rights reserved. No part of this publication may be reproduced in any form without prior written permission of Cherub Technology.



www.nuxefx.com

Made in China

NUX

SCREAM BASS

贝斯模拟过载效果器

使用说明书

感谢您选择NUX的产品！

NUX Scream Bass是一个专门为电贝司而设计的模拟过载效果器。它给你提供宽广的音色范围，从温和的过载到法兹的声音都可以实现！Blend混合旋钮可以平衡原始信号和过载信号。Scream Bass专门为演奏朋克、摇滚和金属乐而生！

产品界面

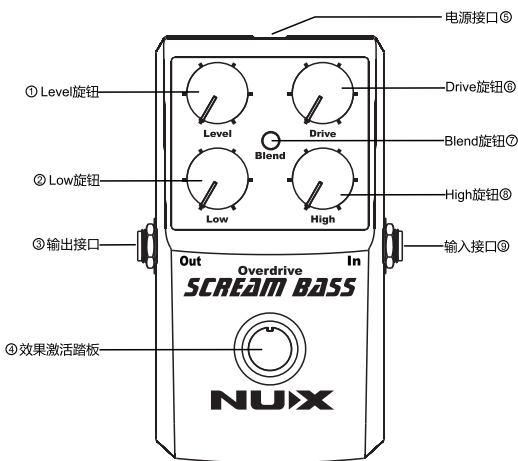

产品特点

- 模拟电路。
- 宽广的音色范围，从过载到法兹。
- 两段均衡调节：低音、高音。
- 干琴和过载信号混合比调节。
- 硬件直通。
- 可用9V电池或选配电源适配器供电。

设备连接

电源接口

用9V外正内负的电源适配器供电。

推荐选配NUX ACD-008A电源适配器。

注意：其它电源有可能导致噪音或者设备损坏。

输入接口

把电贝司的输出或者前一个效果器的输出连接到这个接口。

输出接口

可以连接至电贝司功放或者下一个单块效果器的输入接口。

使用指南

Level旋钮

设定Scream Bass效果器的总输出音量。

Drive旋钮

设定Scream Bass的失真度。

Low旋钮

调节低音的量。

High旋钮

调节高音的量。

Blend旋钮

用于在效果器打开的状态下，平衡原始输入信号与过载信号在输出中的混合比。把Blend旋钮关到最小的时候，输出只有原始信号而无效果；把Blend旋钮开到最大，则只有过载效果信号输出。

- 建议先把Drive、Low、High、Blend旋钮开到中间位置，把Level从0的位置开始慢慢开大，直到得到适合的音量。
- 调节Gain、Bass、Treble旋钮直到得到满意的音色。
- 用Blend旋钮调节原始输入信号和过载信号在输出中的混合比。

关于电池

本机器随包装赠送一颗9V电池，用于测试用途。当效果器电源指示灯变暗，甚至声音不正常时，请更换新的电池。为了避免不必要的电池消耗，在不用效果器时，请把音频线从In输入口中拔出。强烈推荐使用选配NUX ACD-008A电源适配器或者高质量效果器专用电源供电。

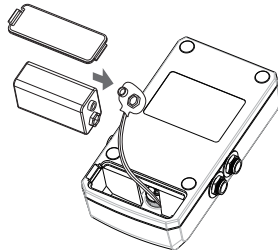

故障排除

电源不能打开

- 检查电源是否正确并安全地连接上。
- 如果用电池供电，尝试换上新的电池。
- 检查In输入接口是否已经连接上音频线。

没有声音

- 尝试把乐器直接连接到此效果器，并直接输出到音箱。确保乐器和音箱的音量都是打开的状态。
- 检查是否所有连接线材都已正确和安全地连接好了。

噪音问题

- 确保所用的电源适配器的技术参数是正确的(DC 9V, \ominus \oplus)。强烈推荐选配NUX ACD-008A电源适配器。用其它的电源有可能导致噪音或者设备损坏。
- 把Drive设置过高和使用单线圈拾音器的吉他会导致噪音升高，尝试把Drive关小。

声音质量差

- 确保所有连接乐器、效果器和音箱的音频线都已正确和安全地连接上。
- 确保所用的电源适配器的技术参数是正确的(DC 9V, \ominus \oplus)。
- 如果用电池供电，电量低可能导致声音不正常，尝试更换新的电池。建议使用新的碱性电池。

技术规格

- 输入: 1 x 6.35mm 单声道输入
- 输出: 1 x 6.35mm 单声道输出
- 输入阻抗: 1M Ω
- 标称输入电平: -20 dBu
- 标称输出电平: -20 dBu
- 输出阻抗: 1 K Ω
- 等效输入噪声级: -110 dBu (IHF-A, Typ.)
- 耗能: < 11mA
- 供电: 9伏电池或者DC 9V电源适配器 \ominus \oplus (选配NUX ACD-008A)
- 尺寸: 122mm (L) x 72mm (W) x 47mm (H)
- 重量: 270g

*技术规格如有变更，恕不另行通知。

注意事项

- 使用环境：
 1. 避免在高温、潮湿、零下等恶劣的环境中使用。
 2. 避免在阳光直射下使用。
- 请勿自行拆卸本机。
- 请保存好本手册以便以后查阅。

随机附件

- 一个9伏电池(仅作测试用途)
- 说明书

质量承诺

亲爱的 **NUX** 用户：

在您使用 **NUX** 产品时，请仔细阅读产品说明书，当您有疑问和困难时，请拨打售后服务热线：**400-990-9866**

- 一周内出现质量问题可退货退款
- 一年内出现质量问题可免费维修
- 一月内出现质量问题可调换
- 终身享有咨询和维修服务

[请向销售商索取有效购买凭证并予以保存]

换修政策

一、包换政策：

1. 消费者自购机之日起1个月之内，在正常使用情况下，出现非人为的产品性能故障，且产品外观及包装保持完好的可向所购机的经销商换机。
2. 消费者在换机时应出示由经销商开出的购机收据及保修卡，否则经销商可以不予更换。

二、保修政策：

- 产品在购买之日起1年内，可免费享有维修服务；对于超过1年的产品及人为或不可抗力因素造成损坏的产品，我司可提供有偿维修服务。

广东省珠海市金鼎镇科技九路10号
珠海市蔚科科技开发有限公司 售后服务部
邮编：519085



www.cherub.cn