

Owner's Manual

TAPE CORE DELUXE

NUX www.nuxefx.com

Copyright
Copyright 2015 Cherub Technology Co. All rights reserved. NUX and TAPE CORE DELUXE are trademarks of Cherub Technology Co. Other product names modeled in this product are trademarks of their respective companies that do not endorse and are not associated or affiliated with Cherub Technology Co.
Accuracy
Whilst every effort has been made to ensure the accuracy and content of this manual, Cherub Technology Co. makes no representations or warranties regarding the contents.

WARNING!-IMPORTANT SAFETY INSTRUCTIONS BEFORE CONNECTING, READ INSTRUCTIONS

WARNING: To reduce the risk of fire or electric shock, do not expose this appliance to rain or moisture. **CAUTION:** To reduce the risk of fire or electric shock, do not remove screws. No user-serviceable parts inside. Refer servicing to qualified service personnel.

CAUTION: This equipment has been tested and found to comply with the limits for a Class B digital device pursuant to Part 15 of FCC Rules. Operation is subject to the following two conditions: (1) This device may not cause harmful interference, and (2) this device must accept any interference received, including interference that may cause undesired operation.

The lightning symbol within a triangle means "electrical caution!" It indicates the presence of information about operating voltage and potential risks of electrical shock. The exclamation point within a triangle means "caution!" Please read the information next to all caution signs.

- Use only the supplied power supply or power cord. If you are not sure of the type of power available, consult your dealer or local power company.
- Do not place near heat sources, such as radiators, heat registers, or appliances which produce heat.
- Guard against objects or liquids entering the enclosure.
- Do not attempt to service this product yourself, as opening or removing covers may expose you to dangerous voltage points or other risks. Refer all servicing to qualified service personnel.
- Refer all servicing to qualified service personnel. Servicing is required when the apparatus has been damaged in any way, such as when the power supply cord or plug is damaged, liquid has been spilled or objects have fallen into the apparatus, the apparatus has been exposed to rain or moisture, does not operate normally or has been dropped.
- The power supply cord should be unplugged when the unit is to be unused for long periods of time.
- Protect the power cord from being walked on or pinched particularly at plugs, convenience receptacles and at the point where they exit from the apparatus.
- Prolonged listening at high volume levels may cause irreparable hearing loss and/or damage. Always be sure to practice "safe listening".

Follow all instructions and heed all warnings
KEEP THESE INSTRUCTIONS!

Thank you for selecting the NUX products! With years of research, we are proud to launch the new generation of the NUX pedals - The Tape Core pedal! It's a tribute to the legendary tape echo with a constrict size.

Tape Core is a compact stomp box that offers classic tape echo tone. Just like the real tape echo, Tape Core has 3 repro heads provided 7 different combinations of delay sounds. All the natural sound, decay, modulation are created by NUX TS/AC Technology! Tape Core is convenient, professional and inspiring!

Features

- 7 delay combinations from 3 repro heads.
- Killer sound quality.
- True Bypass and Buffered Tail Feature.
- Long press the footswitch for Tap Tempo Function.
- Relay Bypass provide quieter switching.
- NUX Original TS/AC Technology.
- 32bit DSP, Hi Performance 24bit 44.1kHz AD/DA Converter

Product Description

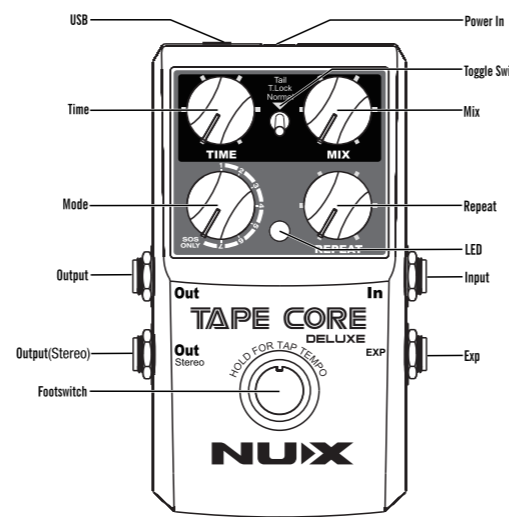

- Time Knob**
Set the delay time.
- Mix Knob**
Set the volume of the repeat.
- Repeat Knob**
Set the number of repeat.
- Mode Knob**
Select delay types.
- Toggle Switch**
Tail: This means the repeats of the delay will not be cut when you bypass the pedal.
T Lock: Put the toggle switch to this position will freeze the current settings.
Normal: This means that the repeats of the delay will be cut off when you bypass the pedal.
- Footswitch**
Using the footswitch to turn on the delay effect or bypass. Long press the footswitch could change to Tap Tempo function to determine the delay time. Under the Tap Tempo function, the longest delay time could be 1.5s.

Connection

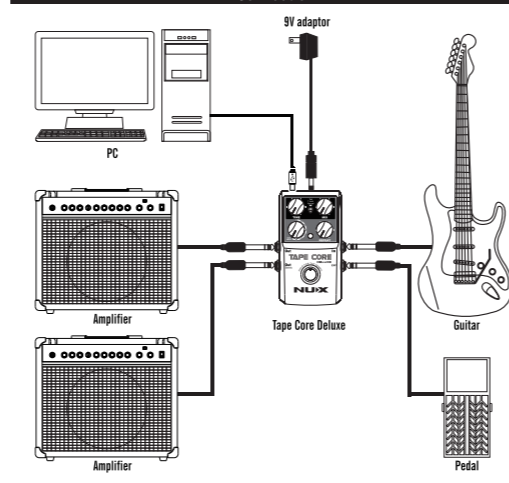

Power In
Connect a 9V (Negative Tip) Adaptor. Optional NUX ACD-008A is recommended.
NOTE: Using other adaptor may cause damage or noise.

USB
For Firmware Updating.

Input
Plug in the instrument to this jack.
NOTE: In jack is also the power trigger, so make sure the In jack is always connected to keep the power on.

EXP
Connect to an expression pedal to control the time knob by foot. Then you could get a special sound while playing.

Output
This outputs the signal to amplifier. For mono effect, use only the Out jack.

Out Stereo
For stereo effect, use both Out and Out Stereo jacks.

Mode

Mode	Description
Mode 1-Repro head1	Mode 1 uses the Repro Head 1 to feedback the repeat, so the delay time is shortest: 55ms-182ms The repeat is similar to triplet note.
Mode 2-Repro head2	Mode 2 uses the Repro Head 2 to feedback the repeat, so the delay time is medium: 110ms-364ms The repeat is similar to quaver.
Mode 3-Repro head3	Mode 3 uses the Repro Head 3 to feedback the repeat, so the delay time is longest: 165ms-546ms The repeat is similar to crochets.
Mode 4-Repro head1 + 2	Mode 4 uses the Repro Head 1 and 2 to get multi repeats.
Mode 5-Repro head2 + 3	Mode 5 uses the Repro Head 2 and 3 to get multi repeats.
Mode 6-Repro head1 + 3	Mode 6 uses the Repro Head 1 and 3 to get multi repeats.
Mode 7-Repro head1 + 2 + 3	Mode 7 uses the Repro Head 1, 2, and 3 to get multi repeats.
Mode 8-Sound on Sound	Sound on sound means the signal record and repeat while return to the original.

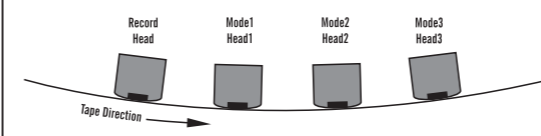

Tone Lock Function

T LOCK
Set the 3-way toggle switch to T Lock position can temporarily freeze the current settings of the knobs. This helps to keep your settings from being changed by accident on stage.

Save and Recall Preset
TAPE CORE DELUXE allows user to save and recall one preset. After you set the effect, while holding down the footswitch, set the toggle switch to T Lock position to save the current effect as the preset. To recall this preset, set the toggle switch to T Lock position before you power the pedal (by plugging in the adaptor and the In jack).

NOTE: Under Tone Locked status or Preset Mode, when a knob is turned to a position that matches the saved parameter, the LED will blink once to remind you the position.

About Battery

A 9V battery is included in the package in purpose of testing. Power adaptor (optional NUX ACD-008A) is strongly recommended for this pedal since the power consumption of this unit is relatively high. If it is powered by battery, change a new battery when the LED goes dim and the sound get distorted. To save battery life, unplug the cable from the In jack when it is not in use.

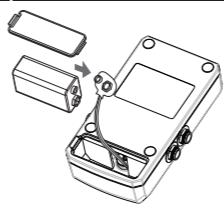

Troubleshooting

Power Does Not Turn On

- Check if the adaptor is connected correctly and securely.
- If it is powered by battery, try a fresh battery.
- Check if the In jack is plugged in.

No Sound

- Try to plug the instrument directly into this pedal and output this pedal directly to the amp, and make sure the volume of the instrument and the amplifier is turned on.
- Check if all the cable connections are good and secure.

Poor Sound Quality

- Make sure all the cables are securely plugged into the pedal, guitar and the playback device, i.e. amplifiers.
- Make sure the power adaptor is with the correct specifications (DC 9V, \ominus - \oplus).
- If it is powered by battery, try a new battery. For longest battery life, we suggest new, high quality ALKALINE battery.

Effects are not responding to knob settings

- Check if you are under Preset mode. Try to set the toggle switch to Normal or Tail position, turn off the power and power on again.
- Check if the toggle switch is in TLock position. If yes, set it to Normal or Tail position.

Specifications

- Effects: 7 repro head combination types and Sound on Sound type.
- Preset: 1
- Nominal Input Level: -20 dBu (GUITAR) +3 dBu (Max.)
- Input Impedance: 1 M Ω
- Nominal Out put Level: -20 dBu (GUITAR) +3 dBu (Max.)
- Output Impedance: 1 k Ω 0 Ω (BYPASS)
- Residual Noise Level: -93 dBu (MIN.)
- Current Draw: 103mA
- Power Supply: 9V Battery, or AC adaptor to the DC 9V \ominus - \oplus (optional NUX ACD-008A)
- Dimensions: 122mm (L) x 72mm (W) x 47mm (H)
- Weight: 270g

*Specification may change without notice.

Precautions

- Environment:**
 - Do NOT use the pedal in high temperature, or high humidity, or subzero environments.
 - Do NOT use the pedal in the direct sunlight.
- Please do NOT disassemble the pedal by yourself.
- Please keep this manual for future reference.

Accessories

- One 9V battery (only for testing purpose)
- Owner's manual

THE FCC REGULATION WARNING (for U.S.A.)

This equipment has been tested and found to comply with the limits for a Class B digital device, pursuant to Part 15 of the FCC Rules. These limits are designed to provide reasonable protection against harmful interference in a residential installation. This equipment generates, uses, and can radiate radio frequency energy and, if not installed and used in accordance with the instructions, may cause harmful interference to radio communications. However, there is no guarantee that interference will not occur in a particular installation. If this equipment does cause harmful interference to radio or television reception, which can be determined by turning the equipment off and on, the user is encouraged to try to correct the interference by one or more of the following measures:

- Reorient or relocate the receiving antenna.
- Increase the separation between the equipment and receiver.
- Connect the equipment into an outlet on a circuit different from that to which the receiver is connected.
- Consult the dealer or an experienced radio/TV technician for help.

CE mark for European Harmonized Standards

CE Mark which is attached to our company's products of Battery mains the product is in fully conformity with the harmonized standards) EN 61000-6-3:2007+A1:2011 & EN 61000-6-1:2007 Under the Council Directive 2004/108/ EC on Electromagnetic Compatibility.

©2015 Cherub Technology-All rights reserved. No part of this publication may be reproduced in any form without prior written permission of Cherub Technology.

www.nuxefx.com Made in China

NUX

TAPE CORE DELUXE 磁带延时效果器 使用说明书

感谢您选择NUX的产品！经过数年的研究，我们很自豪的推出新一代NUX单块效果器—Tape Core Deluxe！我们用这个小巧的单块效果器向传奇的磁带回声致敬。

Tape Core Deluxe提供了经典的磁带回声音色，就像真实的磁带回声。它有三个磁头效果，可提供七种不同组合的延迟音色。所有自然的音色、衰减、调制皆由NUX TSAC技术创造！Tape Core Deluxe操作方便、专业，可以带给乐手无限灵感！

产品特点

- 由三种磁头效果构成的七种延迟组合
- 杀手级的音色质量
- 真直通及硬件尾声保留
- 长压踩钉设定延时功能
- 继电器真直通开关提供更安静的效果切换
- NUX原创的TSAC（仿真模拟电路）技术
- 32bit DSP，高品质24bit 44.1kHz数模转换

产品界面

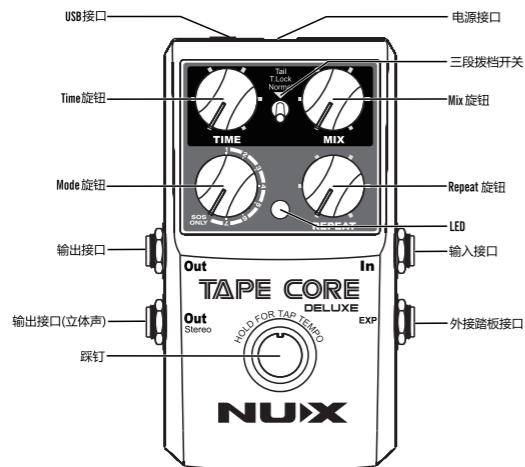

Time 旋钮
设定延时时间。

Mix 旋钮
设定重复的音量。

Repeat 旋钮
设定重复的次数。

Mode 旋钮
选择延时的模式。

三段拨档开关
Tail: 在此模式下，当旁路掉效果器时，重复的尾音不会被切断。
T.Lock: 设定在此模式可防止参数设置的变动。
Normal: 在此模式下，当旁路掉效果器时，重复的尾音会跟着一起切断。

踩钉
使用踩钉可开启或关闭延时效果。长压踩钉进入Tap Tempo功能，可设定延时时间。在Tap Tempo模式之下，延迟时长设定最长可达1.5秒。

设备连接

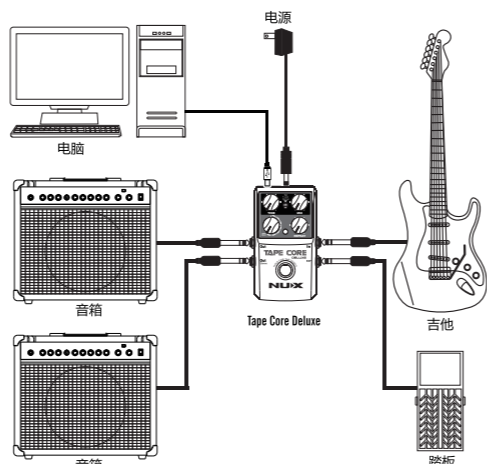

电源接口

连接9V（外正内负）电源适配器。
推荐选配NUX ACD-008A电源适配器。
注意：选用其它适配器可能造成机器损坏或噪音。

USB 接口

可用于软件升级。

输入接口

对于单声道效果，仅使用IN接口，例如一把吉他的单声道信号。
注意：IN接口也是电源触发器，因此IN接口需一直保持连接，以保证机器处于开机状态。

外接踏板接口

连接表情踏板可用脚踏控制延时时间，您可以在演奏时得到特殊的音色。

输出接口

对于单声道效果，仅使用OUT接口。

输出接口(立体声)

对于立体声效果，同时使用OUT和OUT Stereo接口。

模式

模式	描述
模式1-磁头1	模式1使用磁头1制造延时，所以延时时间是最短的：55ms-182ms 延时的音符是接近三连音的。
模式2-磁头2	模式2使用磁头2制造延时，所以延时时间是中等的：110ms-364ms 延时的音符是接近八分音符的。
模式3-磁头3	模式3使用磁头3制造延时，所以延时时间是最长的：165ms-546ms 延时的音符是接近四分音符的。
模式4-磁头1+2	模式4使用了磁头1及磁头2产生多重的延时音符。
模式5-磁头2+3	模式5使用了磁头2及磁头3产生多重的延时音符。
模式6-磁头1+3	模式6使用了磁头1及磁头3产生多重的延时音符。
模式7-磁头1+2+3	模式7使用了磁头1、磁头2及磁头3产生多重的延时音符。
模式8-选声(SOS)	SOS模式下可将音符讯号不断的堆栈，类似Looper的功能。

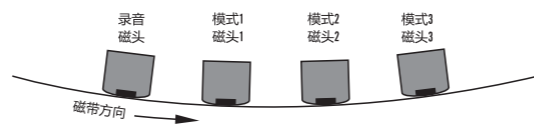

Tone Lock 功能

T.Lock

设置三段拨档开关到T.Lock位置可以暂时锁定当前旋钮的设置，这将帮助您防止在舞台上因误操作而改变设定。

保存和召回预设

TAPE CORE DELUXE允许用户保存和召回一个预设。在您设置效果之后，踩着踩钉，将三段拨档开关拨到T.Lock位置，可将当前的设置保存为预设。要召回预设，可在机器通电前（连接电源适配器和IN接口）将三段拨档开关拨到T.Lock位置。

注意：在锁定音色或预设模式下，当旋钮转动到与存储的参数相匹配的位置时，LED会闪烁一次提醒您这个位置。

关于电池

本机随包装赠送一颗9V电池，用于测试用途。当效果器电源指示灯变暗，甚至声音不正常时，请更换新的电池。为了避免不必要的电池消耗，在不用效果器时，请把音频线从In输入口中拔出。强烈推荐使用选配NUX ACD-008A电源适配器或者高质量效果器专用电源供电。

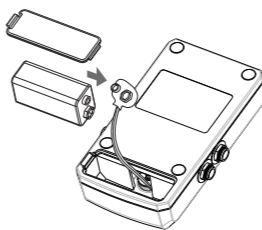

故障排除

无法开机

- 检查电源适配器是否连接正确牢固。
- 如果使用电池供电，请尝试更换新电池。
- 检查In接口是否连接。

没有声音

- 尝试将乐器直接连接到单块，并将单块输出直接连接至音箱，保证乐器和音箱的音量都已打开。
- 检查所有连接线是否连接正确牢固。

声音质量低

- 确保所有连接线与单块、吉他和播放装置（例如音箱）连接牢固。
- 确保使用正确的电源适配器（9V，⊕⊖）。我们强烈建议您选用NUX ACD-008A电源适配器。使用其它适配器可能会造成噪音或故障。
- 如果使用电池供电，请尝试更换电池。为获得最长的电池使用寿命，我们建议您使用新的高质量碱性电池。

转动旋钮无法改变效果

- 检查是否在预设模式下。尝试将三档开关拨到Normal或者Tail位置，关掉电源并再次打开电源。
- 检查切换器是否在T.Lock位置，如果是，将它切换到Normal或者Tail位置。

技术规格

- 效果类型：7种磁头组合类型及选声类型
- 预设数量：1
- 标称输入电平：-20 dBu (吉他)
+3 dBu (最大)
- 输入阻抗：1 MΩ
- 标称输出电平：-20 dBu (吉他)
+3 dBu (最大)
- 输出阻抗：1 kΩ
- 输出：0 Ω (旁路)
- 残余噪声水平：-93 dBu (最小)
- 电流消耗：103 mA
- 电源：9V电池或者9V交流适配器⊕⊖
(可选配NUX ACD-008A 9伏电源适配器)
- 体积：122mm (长) x 72mm (宽) x 47mm (高)
- 重量：270克

* 技术规格如有变更，恕不另行通知。

注意事项

- 使用环境：
 1. 避免在高温、潮湿、零下等恶劣的环境中使用。
 2. 避免在阳光直射下使用。
- 请勿自行拆卸本机。
- 请保存好本手册以便以后查阅。

随机附件

- 一个9伏电池(仅作测试用途)
- 说明书

质量承诺

亲爱的NUX用户：

在您使用NUX产品时，请仔细阅读产品说明书，当您有疑问和困难时，请拨打售后服务热线：400-990-9866

- 一周内出现质量问题可退货退款
 - 一年内出现质量问题可免费维修
 - 一月内出现质量问题可调换
 - 终身享有咨询和维修服务
- [请向销售商索取有效购买凭证并予以保存]

换修政策

一、包换政策：

1. 消费者自购机之日起1个月之内，在正常使用情况下，出现非人为的产品性能故障，且产品外观及包装保持完好可向所购机的经销商换机。
2. 消费者在换机时应出示由经销商开出的购机收据及保修卡，否则经销商可以不予更换。

二、保修政策：

产品在购买之日起1年内，可免费享有维修服务；对于超过1年的产品及人为或不可抗力因素造成损坏的产品，我司可提供有偿维修服务。

广东省珠海市金鼎镇科技九路10号
珠海市蔚科科技发展有限公司 售后服务部
邮编：519085

CE
www.cherub.cn