

Optional accessories: Maxon AC adaptor

model name	input	output	country	polarity
AC2009*1	100VAC to 240VAC	9VDC/2000mA	worldwide	 center-/sleeve+
AC210N	120VAC	9VDC/200mA	USA, Canada	
AC210U	220VAC		Europe (except UK)	
AC210UK	230VAC		UK	
AC210	100VAC	10VDC/200mA	Japan	
AC310	100VAC	10VDC/300mA	Japan	

\*1 Plug type of AC2009 varies with the suffix as shown below.  
Please specify exact model (like AC2009AN, AC2009C) when ordering.

suffix	country	suffix	country
AN	Australia, New Zealand	U	Australia, Belgium, Denmark, Finland, France, Germany, Italy, Netherlands, Norway, Sweden, Switzerland, etc.
C	China	UK	UK
J	Japan		
K	South Korea		
N	USA, Canada		



If you want to dispose this product, do not mix with general household waste.  
There is a separate collection system for used electronics products in accordance with legislation under the WEEE Directive (Directive 2002/96/EC) and is effective only within European Union.

**FCC Class B Equipment, United States Only.**

This equipment has been tested and found to comply with the limits for a Class B digital device, pursuant to Part 15 of the FCC Rules. These limits are designed to provide reasonable protection against harmful interference in a residential installation. This equipment generates, uses, and can radiate radio frequency energy and, if not installed and used in accordance with the instructions, may cause harmful interference to radio communications. However, there is no guarantee that interference will not occur in a particular installation. If this equipment causes harmful interference to radio or television reception, which can be determined by turning the equipment off and on, the user is encouraged to try correct the interference by one or more of following measures:

- Reorient or relocate the receiving antenna.
- Increase the separation between the equipment and receiver.
- Connect the equipment into an outlet on a circuit that is different from that to which the receiver is connected.
- Consult the dealer or an experienced radio or television technician for help.

Declaration of Conformity for Products Marked with the FCC Logo, United States Only. This device complies with Part 15 of FCC Rules. Operation is subject to the following two conditions: (1) this device may not cause harmful interference, and (2) this device must accept any interference received, including interference that may cause undesired operation.

For questions regarding this FCC declaration, contact us by mail, phone or e-mail:

MAXON United States distributor:  
Godlyke, Inc. P.O. Box 3076 Clifton, NJ 07012 USA  
Phone: 973-777-7477

E-mail: info@godlyke.com  
MAXON / NISSHIN ONPA CO., LTD.  
E-mail: sales@maxon.co.jp

To identify this product, refer to the model number found on the product.



# Dual Booster DB10

## User's Guide

◆ SAFETY PRECAUTIONS ◆

Be sure to read these precautions before use for your safe operation of the equipment.  
Keep this User's manual on hand for future reference whenever you need it.

Maxon shall not be held liable to you or any third party for any losses caused by incorrect operation of this equipment, malfunction or any other failure of this equipment to operate as expected, or normal use of this equipment, except to the extent stipulated by law.

Maxon shall not be held liable to you or any third party for any losses related to concerts, exhibitions, or any other type of event due to malfunction or incorrect operation of this equipment.

**NISSHIN ONPA CO.LTD.**

4172-1 Shimauchi, Matsumoto-City, Nagano, 390-0851 Japan  
TEL: +81-263-40-1403 FAX: +81-263-40-1410  
www.maxon.co.jp sales@maxon.co.jp  
For North America info@maxonfx.com

UMN-DB1-0102A Copyright © 1999-2012 NISSHIN ONPA CO., LTD.  
Allright reserved. July 2012 Printed in Japan.

ALL SPECIFICATIONS ARE SUBJECT TO CHANGE FOR IMPROVEMENT WITHO NOTICE OR OBLIGATION.

● SAFETY PRECAUTIONS ● Please be sure to observe.

The safety precautions listed below are intended to ensure your safety whenever you use the equipment.

■ Precaution text is generally accompanied by the following symbols to alert you and others to the risk of personal and material injury that may be caused if the precaution is ignored.

**Warning** This symbol indicates an item that can result in death or serious personal injury if ignored.

**Caution** This symbol indicates an item that can result in serio us personal injury or material damage if ignored.

■ Precaution text is generally accompanied by the following icons to alert you and others to things you should or should not do.

..... A triangle indicates something you should be careful about.

..... A circle with a line through it indicates something you should not do.

..... A black circle indicates something you must do.

**Warning**

**NEVER OPEN THE CASE**  
 • Never try to remove the bottom cover except for battery replacement and to modify the equipment. of the equipment. Internal components use high voltages, and exposing them creates the danger of fire and electrical shock.))

**STOP THE USE IN CASE OF A PROBLEM**  
 • Stop using the equipment whenever you notice smoke or a strange odor coming from it.  
 • Contact your original dealer or nearest authorized service provider for service.



**Warning**

**BEWARE OF HEAT BUILD-UP**  
 • Never cover AC adaptor with cloth or other objects. (Built up heat creates the danger of the equipment deformation and fire.)

**Caution**

**USE SPECIFIED AC ADAPTOR ONLY**  
 • Be sure to use only the AC adaptor specified in this User's Guide. Use of non-specified AC adaptors creates the danger of fire and electrical shock.

**UNPLUGGING AC ADAPTOR**  
 • Never try to unplug AC adaptor while your hands are wet. Doing so creates the danger of electrical shock.  
 • When unplugging AC adaptor from the power source, be sure to grasp the adaptor. Never pull on the cord. Doing so can dam age the power cord and create the danger of fire and electrical shock.

**WATER, HUMIDITY, DUST AND HIGH TEMPERATURES**  
 • Never leave or use the equipment in bathrooms, the outdoors or other areas subject to water, high humidity, dust and high temperature. Doing so creates the danger of fire and electrical shock.

**LEAVING THE EQUIPMENT UNATTENDED**  
 • Whenever leaving the equipment unattended for long periods, be sure to unplug AC adaptor from the power source. If not, there is a danger of fire.



## Dual Booster DB10

- Maxon Dual Booster DB10 is the most compact dual boost pedal with two completely-independent boosters, Vintage and Clean. Maxon DB10 is a unique pedal with these functions built into a small-sized enclosure.
- Clean Boost brings your tone to the foreground of the band ensemble without affecting your original tone. Vintage Boost has a natural high frequency roll-off, which gives soft and unintentional saturation to an amp and power to guitar sound.
- Maximum gain of both Vintage Boost and Clean Boost is approx. 20dB. Ideal pedal to bring your amp's character out. Creates best performance when combined with a tube amp.

## FEATURES AND CONTROLS

- ① Vintage INPUT (vintage input jack)  
Input jack for vintage booster. Connects to the output of guitar, other effects or related equipment. The product automatically turns on when a plug is inserted into this jack. When not in use, disconnect plug from input jack to preserve battery life.
  - ② Vintage LEVEL (vintage control knob)  
Adjusts input signal of 1. Turn this knob CW for large boost.
  - ③ Vintage OUTPUT (vintage output jack)  
Output jack for vintage booster. Connects to the input of amp or other effects.
  - ④ Vintage FOOTSWITCH (bypass/effect switch)  
Bypass/effect switch for vintage boost. Stepping on this switch alternately turns effects on (LED on) and off (LED off)
  - ⑤ Vintage INDICATOR (LED indicator)  
The LED lights when vintage effect is on. The light is turned off at bypass status. LED brightness synchronizes with battery condition.
  - ⑥ Clean INPUT (clean input jack)  
Input jack for clean booster. Connects to the output of guitar, other effects or related equipment. The product automatically turns on when a plug is inserted into this jack. When not in use, disconnect plug from input jack to preserve battery life.
  - ⑦ Clean LEVEL (clean control knob)  
Adjusts input signal of 6. Turn this knob CW for large boost.
  - ⑧ Clean OUTPUT (clean output jack)  
Output jack for clean booster. Connects to the input of amp or other effects.
  - ⑨ Clean FOOTSWITCH  
Bypass/effect switch for clean booster. Stepping on this switch alternately turns effects on (LED on) and off (LED off).
  - ⑩ Clean INDICATOR (LED indicator)  
The LED lights when clean effect is on. The light is turned off at bypass status. LED brightness synchronizes with battery condition.
  - ⑪ DC INPUT (power input jack)  
Jack for connection of external power supply to effect.
- ⚠ No LED light indicates the battery is low or not installed. In this case replace the battery.
- ⚠ Turn down amplifier's volume to the minimum before connecting AC adaptor to the product in order not to damage other connected equipment.

- Each Boost has independent input/output, which provides unlimited sound combination when another guitar effect (such as Maxon OD808 or OD9, etc) is used between Vintage Boost and Clean Boost.
- TBS (True Bypass Switching) with 3PDT mechanical switches for both Vintage Boost and Clean Boost. No tone changes when switching bypass and effect.
- LEDs to indicate bypass/effect and battery condition for trouble-free performance.
- Two-way power operation, using 9V battery or optional AC adaptor.

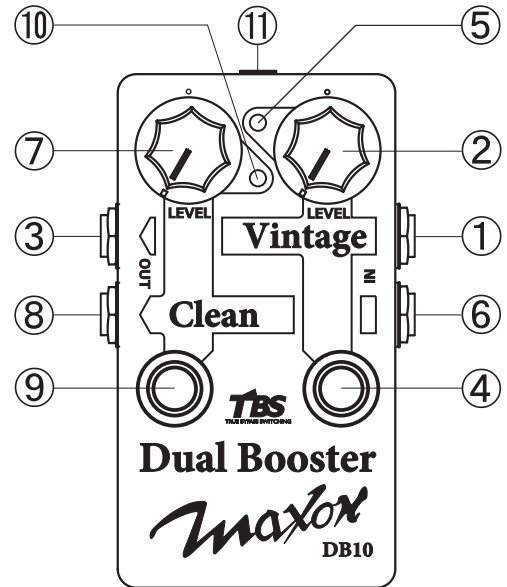

## CONNECTION DIAGRAM

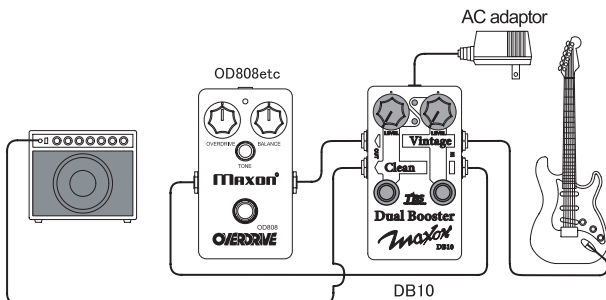

⚠ Certain connections to other equipment may create ground loops that can cause hum.

## SPECIFICATIONS

Input Impedance	: 500k ohms
Output Impedance	: 10k ohms
Controls	: Vintage LEVEL, Clean LEVEL
Switch	: Vintage Bypass/Effect (3PDT True Bypass), Clean Bypass/Effect (3PDT True Bypass)
Indicator	: Vintage Bypass/Effect LED, Clean Bypass/Effect LED
Gain	: Vintage 6 to 19dB at 400Hz Clean 0 to 21dB at 400Hz
Equivalent Input Noise	: Vintage -95dBu or less (Input shorted, IHF-A weighted) Clean -105dBu or less (Input shorted, IHF-A weighted)
Power Supply	: 6F22/6LF22 9V battery x 1 or Maxon AC adaptor
Power Consumption	: 11mA / 9VDC
Battery Life	: 9VDC manganese battery 41 hours 25 deg C (FUJITSU 6F22) 9VDC alkaline battery 67 hours 25 deg C (TOSHIBA 6LF22)
Dimensions	: 70(W) x 113(D) x 54(H)mm (with protrusion)
Weight	: Approx. 290g (incl. battery)
Accessory	: 6F22 9V battery x 1, operating manual

\*0dB = 0.775Vrms

\*All specifications are subject to change for improvement with notice or obligation.

## BATTERY REPLACEMENT

DB10 operates on one 9V battery (6F22 or 6LF22).  
Follow the procedures below to replace a battery.

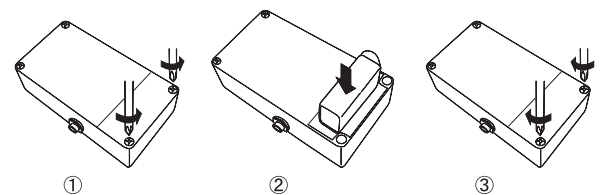

\* Be sure the battery is firmly connected to battery snap with the correct polarity.

## ATTENTION:

- Turn down the volume of effect and amplifier to the minimum before connecting Maxon effects to guitar, amplifier or other effects in order not to damage other connected equipment by unintended noise.
- When not in use, disconnect plug from input jack to preserve battery.
- Take out the battery if the product is not used for a long period of time.
- No or dark LED light indicates the battery is low or not installed. In this case replace the battery to avoid poor effect or distorted signal.
- Be sure to use the correct Maxon AC adaptor. Use of any other adaptor may cause trouble.
- Do not try to remove screws.