

KAM

INSTRUCTION MANUAL

Kam Partybar Eco

Portable performance lighting rig

M A N U A L V E R S I O N 2 . 0
1 2 - 1 6

For the latest instruction manual updates and information on the entire Kam range visit:

www.kam.co.uk

Kam products are manufactured by: **Lamba plc**, Unit 1, Southfields Road, Dunstable, Bedfordshire, United Kingdom LU6 3EJ

Telephone: (+44) (0)1582 690600 • Fax: (+44) (0)1582 690400 • Email: mail@lambapl.com • Web: www.lambapl.com

If this product is ever no longer functional please take it to a recycling plant for environmentally friendly disposal.

Due to continuous product development, specifications and appearance are subject to change.

© Copyright Lamba plc. E&OE.

Thank you for purchasing this Kam product, we are sure that it will serve you for many years to come.

To optimise it's performance, please read these instructions carefully to familiarise yourself with the basic operations of the unit. Please retain them for future reference. This unit has been tested at the factory before being shipped to you. To prevent or reduce the risk of electrical shock or fire, do not expose the unit to rain or moisture. To prevent a fire hazard, do not expose the unit to any naked flame sources. Unplug this apparatus during lightning storms or if it is unlikely to be used for long periods of time.

When installing the unit, please ensure you leave enough space around the unit for ventilation. Slots and openings in the unit are provided for ventilation to ensure reliable operation of the product and to protect it from overheating. To prevent fire hazard, the openings should never be blocked or covered.

The unit is powered by the mains, always handle the power cable by the plug. Never pull out the plug by pulling on the cable. Never touch the power cable when your hands are wet as this could cause an electric shock. Do not tie a knot in the cable. The power cable should be placed such that it is not likely to be stepped on. A damaged power cable can cause a fire or give you an electrical shock. Check the power cord periodically, if you ever find that it is damaged, replace it before using the unit again. Contact your retailer for a replacement. The voltage of the available power supply differs according to country or region. Be sure that the power supply voltage of the area where this unit is to be used meets the requirements of the unit.

The lightning flash symbol inside a triangle is to alert the user to the presence high voltage within the unit's enclosure that may be of sufficient power to constitute a risk of electrical shock to persons. Caution: to prevent the risk of electric shock, do not attempt to open the unit. No user-serviceable parts inside. Refer all servicing to qualified service personnel. The exclamation mark inside a triangle is intended to alert the user to the presence of important operating and maintenance instructions in the literature accompanying the appliance.

Select the installation location of your unit carefully. Avoid placing it in direct sunlight or locations subject to vibration and excessive dust. Do not use the unit where there are extremes in temperature (- 20°C to 40°C).

Unpacking and safety Please unpack your new product carefully. Your new product should reach you in perfect condition. Please check that no damage has occurred during transit. If any damage is found, do not operate your unit. Please contact the retailer you purchased it from immediately. Always disconnect the unit from the mains when carrying out any cleaning of the unit.

Manufacturer declarations



In compliance with the following requirements: **RoHS Directive (2002/95/EU)** and **WEEE Directive (2002/96/EU)**.
If this product is ever no longer functional please take it to a recycling plant for environmentally friendly disposal.

CE declaration of conformity

R&TTE Directive (1999/5/EU), EMC Directive (2004/108/EU), Low Voltage Directive (2006/95/EU).
The declarations are available on application from certification@lambapl.com
Before putting the devices into operation, please observe the respective country-specific regulations.

The unit is supplied with a power plug appropriate to its voltage. Should any other connections be required they must be carried out with the following configuration:

Cable (EU)	Cable (US)	Pin	International
Brown	Black	Live	L
Light blue	White	Neutral	N
Yellow/green	Green	Earth	

DMX-512 connection

If you are using a standard DMX controller, you can connect the DMX output of the controller directly to the DMX input of the first unit in a DMX chain. If you wish to connect a DMX controller with other XLR outputs you will need to use adapter cables.

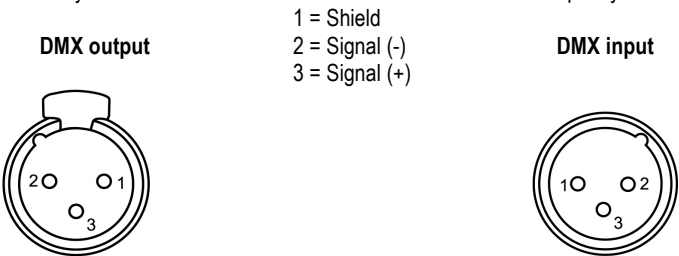

Connect the DMX output of the first unit in a DMX chain with the DMX input of the next unit in the chain. Always connect the output of one unit with the input of the next unit until all units are connected.

Unit features & functions

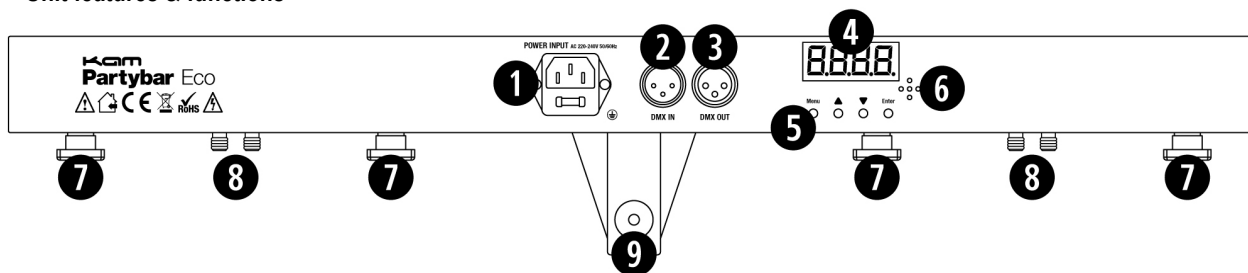

Number	Feature	Function
1	Power supply input	Attach the IEC mains cable here. Built-in fuse.
2	DMX input	3 pin XLR connector for DMX512 input communication.
3	DMX output	3 pin XLR connector for DMX512 output communication.
4	LED display	LED function display and menu buttons to control the operating mode of the unit.
5	MENU buttons	MENU function buttons x 4 (see below for operation).
6	Mic	Built-in microphone for Sound-to-Light operation.
7	Par can mounts	Attach the par can lights to the controller bar at the 4 points shown.
8	Par can connections	Attach the par can cables to the controller bar at the 4 points shown.
9	Light stand socket	Tighten screw to secure the controller bar to the light stand.

Function setting

Using the four function buttons on the controller bar you can set the operating mode of the unit. Press the **Menu** button to display the different functions (see table below for a description of the functions). Use the **Up** or **Down** arrow buttons to make your selection. When you have chosen your desired function, press the **Enter** button to confirm the change.

Number	Display	Function	
1	d001-d512	001-512	DMX address setting.
2	IP.01-IP.64	001-512	IP mode.
3	A1.01	A1.01-A1.18	Static colour mode A1.01-A1.32 - press the Enter button to save.
4	A2.01	A2.01-A2.32	Jump change colour mode A2.01-A2.32 - press the Enter button to save.
5	A3.01	A3.01-A3.19	Multicolour mode A3.01-A3.32 - press the Enter button to save.
6	A4.01	A4.01-A4.19	Sound activated mode A4.01-A4.32 - press the Enter button to save.
7	A5.01	A5.01-A5.19	Strobe mode A5.01-A5.32 - press the Enter button to save.
8	r.000-r.255		Adjust the red colour intensity up or down.
9	G.000-G.255		Adjust the green colour intensity up or down.
10	b.000-b.255		Adjust the blue colour intensity up or down.
11	u.000-u.255		Adjust the white colour intensity up or down.

DMX address setting - When controlling the unit (or units) with a DMX controller, each one must be set with a specific DMX address. You can choose to set all units with the same DMX address or you can set every unit with its own DMX address. If all units are set with the same DMX address all units will be synchronised and operate in the same way.

If you set each unit with a different DMX address, they will receive the DMX signal from their own DMX address. You will now be able to control each unit individually. The DMX address that you set for each unit must be determined by the number of channels. This unit has 8 DMX channels, therefore you should set the starting address of the first unit to 1, the second unit must be set to 9 (1+8), the third to 17 (9+8), the fourth to 25 (17+8) and so on.

8 channel DMX mode

Channel	Value	Function
1	0-10	No function
	11-50	Macro A1
	51-100	Macro A2
	101-150	Macro A3
	151-200	Macro A4
	201-255	Macro A5
	210-255	Red+green+blue
2	0-255	Macro colour
3	0-255	Speed adjustment
4	0-255	Master dimmer
5	0-255	Red dimmer
6	0-255	Green dimmer
7	0-255	Blue dimmer
8	0-255	White dimmer

Remote control operation

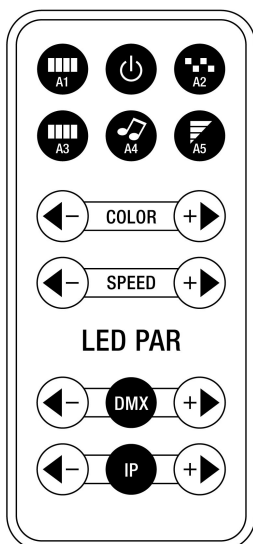

A1 button effect 1 – all lights on

Power button

A2 button effect 2 – colour jump change

A3 button effect 3 – colour gradual change

A4 button – sound activated mode

A5 button – strobe mode

< **colour buttons** > – colour adjustment

< **speed buttons** > – speed adjustment

< **DMX buttons** > – DMX channel selection

< **IP buttons** > – running effect

Product specification

Mains power / rated power	AC 220~240V, 50/60Hz / 60w
Control modes	8 channel DMX512 / Auto / Sound-to-Light / Master/Slave / Remote control
Light source	4 par cans with 12 x 1w RGBW LEDs (red, green, blue & white)
Operating temperature	-20°C to 40°C
DMX512 connections	3 pins XLR male/female
Dimensions (WxDxH)	750 x 190 x 92mm (not including stand)
Weight	6.25Kg

Due to continuous product development, specifications and appearance are subject to change.