

# KATANA Series Version 2 Supplementary Manual

A function to switch between BANK A/B has been added to TONE SETTING. This doubles the number of settings that can be stored.

## KATANA-50

BANK A	CH1, CH2
BANK B	CH1, CH2

## KATANA-100, KATANA-100/212, KATANA-HEAD

BANK A	CH1, CH2, CH3, CH4
BANK B	CH1, CH2, CH3, CH4

## Switching Banks from the Main Unit

1. With one of the channels [CH1]–[CH4] selected, hold down the [PANEL] button for approximately one second.

The selected [CH1]–[CH4] button blinks, and the bank switches between BANK A and BANK B. When BANK B is selected, the [PANEL] button blinks slowly.



\* You can't switch banks while PANEL is selected.

## Switching Banks from a Footswitch

If you connect a footswitch (sold separately: BOSS FS-6, FS-7, or FS-5L) as shown in the illustration below, you can use your foot to switch between BANK A and BANK B, and between CH.1 and CH.2.

\* Pin assignment of FOOT CONTROL jack

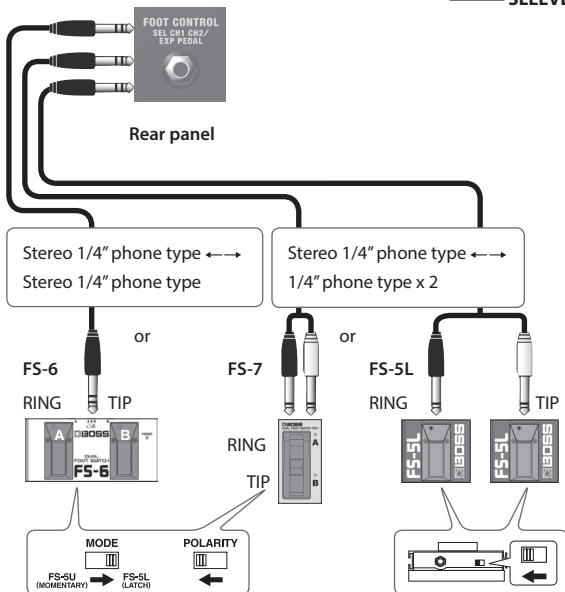

Switch	Explanation
TIP	Switches between CH1 and CH2.
RING	Switches between BANK A and BANK B.

\* The KATANA is compatible with latch-type footswitches (FS-6, FS-7, FS-5L). If you're using an FS-6 or FS-7, set the mode of A and B to FS-5L (LATCH). Momentary-type footswitches (e.g., FS-5U) cannot be used.

## Switching Banks from a GA-FC

\* You can use a GA-FC foot controller (sold separately) connected to the KATANA-100, KATANA-100/212, or KATANA-HEAD to switch banks.

1. With one of the channels [CH1]–[CH4] selected, hold down the [PANEL] switch for approximately one second.

The selected [CH1]–[CH4] button blinks, and the bank switches between BANK A and BANK B. When BANK B is selected, the [PANEL] button blinks slowly.

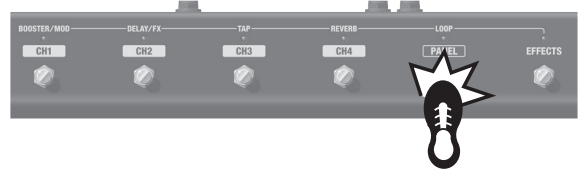

\* You can't switch banks while PANEL is selected.

### MEMO

If a footswitch (sold separately: FS-5U) is connected to the rear panel VOLUME jack or the FX jack, you can use it to instantly switch between BANK A and BANK B.

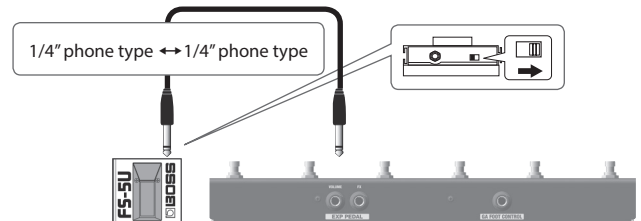

## Restoring the Factory Settings

Here's how the settings stored in the KATANA can be returned to their factory-set condition (factory reset).

1. While holding down the [PANEL] button, turn the power on.

Each of the EFFECTS buttons continues blinking consecutively from the left. When the blinking stops, all of the KATANA's settings return to the factory-set state.



\* It takes approximately 30 seconds for the factory reset to be completed. Don't turn off the power while the factory reset is in progress.

## About version 2 of the dedicated software

We have expanded the effects and functionality that you can use in this dedicated computer software.

- Download the latest software from the download site BOSS TONE CENTRAL (<http://bosstonecentral.com/>).

