

GRANDVIEW®
GRANDVIEW REPRODUCING GENUINE COLORS

**Instruction Manual for
Cyber Series Intellectualized-Controlled Screen**



Model: CB-Mlxx

GRANDVIEW®
GRANDVIEW REPRODUCING GENUINE COLORS

Grandview Crystal Screen Canada Ltd.
#11- 3751 North Fraser Way,
Marine Way Business Centre,
Burnaby, BC, Canada V5J 5G4
Tel: 1-604-412-8777 Fax: 1-604-412-8796
Website: www.grandviewscreen.ca

Guangzhou Grandview Crystal Screen Co., Ltd.
P.O. 511400 Federal Ind. Zone No. 363, Yushan West Road,
Shiqiao, Panyu District, Guangzhou, Guangdong, China
Tel: +8620-8489-9499 Fax: +8620-8480-3343
Website: www.grandviewscreen.com
www.grandviewscreen.com.cn



Thank you for purchasing a Grandview projection screen.
Before use, please read instructions carefully. After installation, store instructions for future reference.

GRANDVIEW®

Description

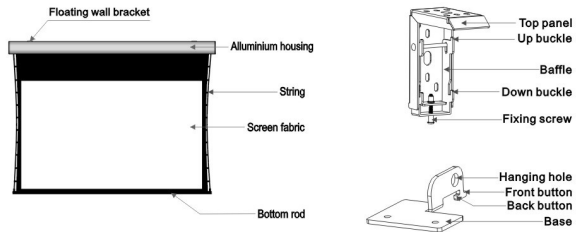

Accessories

- Floating wall bracket (2pcs)
- ∅5 x 40mm Tapping screw & cap (8sets)
- Ceiling hanger (2pcs)
- External IR Receiver (1pc)
- M6x10 Screw (4pcs)
- Trigger line (1pc)
- Allen key (1pc)
- Instruction manual (1pc)

Motorized Screen Power Specifications

Voltage	Frequency	Watts	Application
230V/120V/100V	50Hz/60Hz	90W/80W	Applies up to 120" motorized screens

Installation

Take out all the parts from the packaging and follow the accessories guideline to ensure you have all parts. There are three installation measures for this product, namely wall mounting, ceiling mounting and ceiling hang. The installed distance can be changeable up to your needs via adjusting the slipper block, while the ideal position is the mounting bracket is at its nearest point to the endcap, which can reduce unnecessary vibration or noise.

Floating wall bracket installation

1. Choose screws for mounting according to wall material. (Tips: Wood screws for wood wall, and Tapping screws for concrete wall.)
2. Mount the brackets onto the wall, assuring they are at the horizontal level. (Tips: draw an erasable level line when mounting the brackets) (Figure 1) Here below are the details:

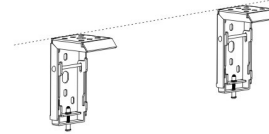

Figure 1

Installation Steps

- a) Wood wall and ceiling installation: Drill in the ∅5 x 40 screws through the appropriate holes in the bracket (Figure 2-3).
- b) Drywall and ceiling and installation: Install the anchors and drill in the ∅5 x 40 screws into the appropriate bracket holes. (Figure 4-5).

Wood wall installation Wood ceiling installation Concrete wall installation Concrete ceiling installation

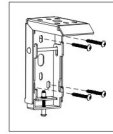

Figure 2

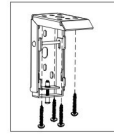

Figure 3

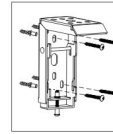

Figure 4

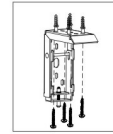
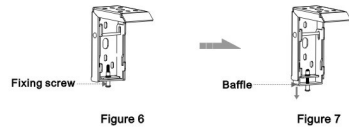
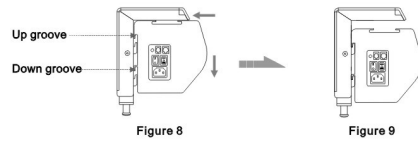

Figure 5

3. Loose the Fixing screw to lower down the Baffle all the way. (Figure 6-7)



4. When mounting the screen onto Floating wall brackets, make sure the Up groove and the Down groove on the housing match with the Up buckle and the Down buckle on the bracket separately. (Figure 8-9)



5. Fasten the Fixing screw on the bracket, to fix housing tightly onto the brackets.(Figure 10-11)

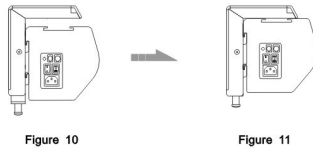

Floating hanging bracket installation

To choose the tapping screws with hanger or other screws with hanger (unprovided) according to ceiling material. (Tips: Wood screws $\varnothing 5 \times 60$ for wood ceiling and tapping screws for concrete wall.)

1. To drill two same holes with an electric drill horizontally with wall, then fasten hangers(unprovided) onto the ceiling. (Figure 12)

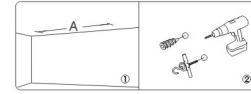

Figure12

2. Incline the ceiling hanger to a certain degree to make the hanger hole go through the oval hole in the middle of top side of the wall bracket. Then level the ceiling hanger to ensure that the base clings to the top of wall bracket, so that the front button can go right through the wall bracket's fixing hole. Push the ceiling hanger ahead until the front button fully locks the top panel of the wall bracket. Fix the ceiling hanger to the wall bracket with the help of M6x10 size of screws. (Figure 13-14) (Note: Make sure the front button of the ceiling hanger fully lock the top side panel of the wall bracket to prevent the screen falling down.)

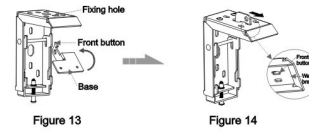

Figure 13

Figure 14

3. After fix the ceiling hanger, make sure the up groove and the down groove on the housing match with Up buckle and Down buckle on the bracket separately and fasten the fixing screw on the bracket, to fix housing tightly onto the brackets.(Figure 15-16)

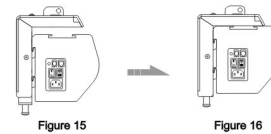

Figure 15

Figure 16

4. After finished step 2 and step 3, check whether wall bracket fix on the housing of screen tightly then you can hang the screen according to the figure 17.

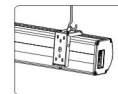
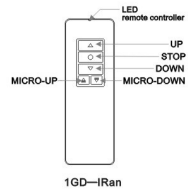

Figure 17

Instructions



Controller button instruction

1. To raise screen press "UP".
2. To hold screen at desired position press "STOP".
3. To lower screen press "DOWN".
4. To raise the screen little at your desired position press "MICRO-UP".
5. To lower the screen little at your desired position press "MICRO-DOWN".

Caution:

1. The shortest distance between receiver and controller is 0.5 meter.
2. Controller will work within 30 degree away horizontally from the center of receiver point within 8 meters from the screen.
3. The controller will not work if the signal was covered by something.
4. Keep the controller far away from high temperature and humid situation.
5. Please change the battery when the signal is weak.
6. Please take the battery out if the controller was not being used for long time.
7. Please choose the same type battery as original supplied.

How to install the battery:

1. Turn the controller around, push to open the cover as guide arrow.
2. Put the battery in according the guide of cathode and anode.
3. Close the cover.

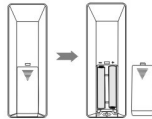

5

Operation Instruction

Power Cord Connecting Screen:

1. Plug the power cord into the power jack on the left end cap (Figure 18-19). (Attention: The plug slot must be matched with the power jack slot)



Figure 18



Figure 19

2. Tear off the glue cloth fixed on the bottom rod, ensure the bottom rod is not stuck by the casing.
3. Switch on the power (within stated voltage).

How to use Manual/Remote Control Switch Button: (Figure 20)

The screen has four kinds of optional control methods: IR Remote Control, Manual Control, Trigger Control, External Control (Central Control or RS232/USB). When switching the Manual/Remote Control Switch Button to position "1", you can use Manual Control or Trigger to control up/pause/down of the screen. When switching to position "0", you can use IR Remote Control or External Control (Central Controller or Rs232/USB) to control up/pause/down of the screen.

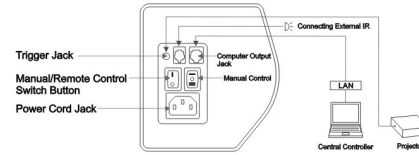

Figure 20

How to use manual switch control:

1. Switch Manual/Remote Control Button to position "1" (manual stalls).
2. Turn the switch to position "=" to lower the screen; it will come down slowly. When it is all the way down, it will stop automatically (Figure 22).
3. Turn the switch to position "-" to lower the screen; it will go up into the metal casing. When it is all the way up, it will stop automatically (Figure 23).
4. To stop any time while the screen is in motion, turn the switch to 0.

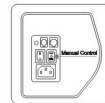

Figure 21

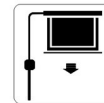

Figure 22

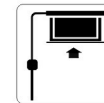

Figure 23

6

How to use Trigger Control:

1. Insert one end of the signal cable into the Trigger jack of the handle controller, and the other end into the DC5V-12V output hole of the projector (Figure 24-25).
2. Press the control switch of the handle controller to the "—" location.
3. Switch Manual/Remote Control Button to position "1" (manual stalls).
4. When running the projector, the screen will spread the fabric automatic by synchronous; when closing the projector, screen will be back automatic by synchronous too.
5. If you don't need to use the trigger control, please draw off the burst line directly, then control it by your hand.

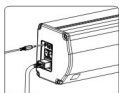

Figure 24

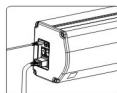

Figure 25

How to use External Control (Central Controller or RS232/USB):

1. Turn the manual/IR remote control switch to position "0" (remote control stalls)
2. Plug one side of the signal cord into the computer output jack at left side of the screen's end cap, the other side of the signal cord to plug into the jack of Central Controller or computer RS232/USB (Note: in order to use RS232 Control, an Adapter is necessary to be connected with, the Adapter is not in the accessory package)(Figure 26-27), and then you can control up/pause/down of the screen via Central Controller or computer.



Figure 26



Figure 27

How to use IR Remote Control:

1. Turn the manual/IR remote control switch to position "0" (remote control stalls)
2. When there's nothing to keep our of the IR window, you can use the controller to control up/pause/down of the screen (Figure 28).
3. For hidden installation or IR window is being kept out by something, please take out the IR Receiver Head and plug it to the revealant hole, and then install it at the position where IR signal is available (Figure 29)

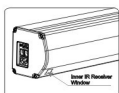
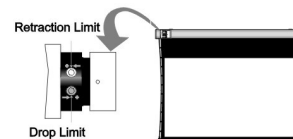

Figure 28



Figure 29

To avoid overheating the motor, do not continually retract and lower the screen for over 4 minutes at a time. If the motor overheats, it will need a cool down time of 2 minutes. The motor does not need any lubricants. The drop and retract limit of the screen is factory preset to an optimal configuration. Please ask your local dealer or professional to adjust settings to avoid damaging the motor.



How to adjust tension situation of the string

If the string is loose which is caused by bump on transportation or faulty operation (Figure 30), please rotate the String Adjustment Knob clockwise to make string tensional (Figure 31). If the string is over-tensional, please press the String Releasing Button and then rotate the String Adjustment Knob counter-clockwise to suitable tensional situation (Figure 32).

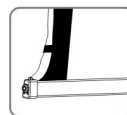

Figure 30



Figure 31

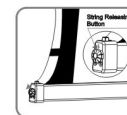







Figure 32

Warnings

- The ceiling or wall used for fixture installation must be secure to prevent the screens from falling.
- While installing electrical motors, please hire professionals or your local dealer to ensure safety. A misconnection may lead to fire or leaks.
- Make sure the Fixing screw be fastened when using the wall bracket, to avoid any damage.
- Keep all infrared wireless products away from fluorescent lighting as it may cause malfunctions.
- Please read the following as any damage to the screen surface will affect the quality of the picture:
 1. Avoid contact or touching the screen surface as it may cause scratches or tears.
 2. Do not write or draw on the surface.
 3. Clean the screen with a soft cloth and lukewarm water. Do not use any detergent or cleaning products.
- Roll up the screen after every use. Ensure that the screen is level when installing; do not pull on the sides or fold the screen.
- To prevent unnecessary damage, the operating and maintenance of the screen should be done by adults.

 Ignoring the safety warnings may lead to injuries and/or damaging the product.	 Fixtures should be installed in a secure place to avoid accidents or the screen falling.
 Do not connect any electrical attachments or remote controls.	 Roll up the screen after every use. Leaving it hanging for a long period of time may cause the fabric to loosen.
 Please contact your local dealer for repairs or maintenance. Please contact our company if you have any further questions. Avoid taking apart the fixtures yourself. Loose parts may cause the screen to fall.	 Refrain from hanging anything on the screen as it may cause the screen to fall.

Do not take apart and replace with unknown parts. If there are any problems, please contact your local dealer. Product specifications are subject to change.