

ortofon

Knowing the fundamental headshell dimensions will in a lot of cases make it easier to mount and align cartridge and tonearm correctly:

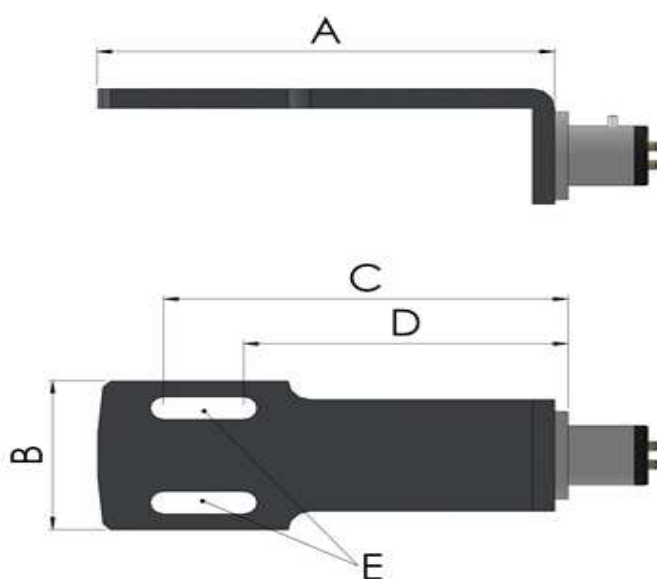

HEADSHELL MODEL	A Headshell length	B Headshell width	C Mounting distance max.	D Mounting distance min.	E Screw diameter max.
SH-4	51.5 mm	20.0 mm	44.0 mm	35.0 mm	3.0 mm
LH-2000	50.3 mm	20.0 mm	44.0 mm	35.7 mm	N/S
LH-6000	47.7 mm	19.1 mm	41.7 mm	34.0 mm	N/S
LH-8000	50.5 mm	19.0 mm	42.1 mm	32.7 mm	N/S
LH-9000	52.0 mm	20.0 mm	45.0 mm	38.2 mm	N/S
LH-10000	51.2 mm	19.4 mm	42.0 mm	42.0 mm	2.7 mm