

Reference Manual – English

CD PLAYERS

CD555 • CDX • CD5 XS • CD5si



Contents

<u>Section</u>	<u>Page</u>
Introduction	E1
1. Connections	E1
2. Mains Power	E1
3. General Installation	E2
CD555	E3
4. CD555 Introduction and Installation	E3
5. CD555 Connections	E4
6. CD555 In Use	E5
CDX2	E6
7. CDX2 Introduction and Installation	E6
8. CDX2 Connections	E6
9. CDX2 In Use	E7
CD5 XS	E8
10. CD5 XS Introduction and Installation	E8
11. CD5 XS Connections	E8
12. CD5 XS In Use	E9
CD5si	E10
13. CD5si Introduction and Installation	E10
14. CD5si Connections	E10
15. CD5si In Use	E10
16. CD Player Control and Operation	E11
17. R-com Remote Handset	E12
18. NARCOM 5 Remote Handset	E13
19. Diagram Icons	E14
20. Puck Identification	E14
21. Declarations of Conformity	E15
22. Statutory Safety Warnings	E15

Introduction

Naim Audio products are conceived with performance as the top priority. Careful installation will help ensure that their full potential is achieved. This manual covers the CD555, CDX2, CD5 XS and CD5si CD players and their associated or upgrade power supplies. It begins with some general installation notes and statutory safety warnings. Product specific information begins in Section 4.

Note: Please read the Statutory Safety Warnings found at the end of this manual.

1. Connections

It is important for both safety and performance that the standard cables supplied are not modified.

1.1 Interconnect Cables

If options are available with your equipment and installation, DIN interconnect sockets should be used in preference to RCA Phono sockets. One end of each Naim interconnect cable is marked with a band to establish its correct orientation. The band denotes the end that connects to the signal source. Naim Hi-Line interconnect cable will provide the best results.

Interconnect plugs and sockets should be kept clean and free from corrosion. The easiest way to clean them is to switch off the equipment, pull the plugs out of their sockets, and push them back in again. Contact cleaners and “enhancers” should not be used as the film they deposit may degrade the sound.

2. Mains Power

Where fused plugs are used 13 amp fuses should be fitted. Fuses of a lower rating will fail after a period of use. Do not wire voltage dependent resistors or noise suppressors into mains plugs. They degrade the mains supply and the sound.

2.1 Mains Plug Wiring

In some territories a mains plug may need to be fitted to the supplied mains lead. As the colours of the wires in the mains lead may not correspond with the coloured markings identifying the terminals in the plug proceed as follows:

The wire coloured GREEN-AND-YELLOW must be connected to the terminal in the plug marked by the letter E or by the safety earth symbol or coloured GREEN or GREEN and YELLOW.

The wire coloured BLUE must be connected to the terminal in the plug marked with the letter N or coloured BLACK.

The wire coloured BROWN must be connected to the terminal in the plug marked with the letter L or coloured RED.

2.2 Equipment Fuses

Mains powered Naim Audio equipment is fitted with a mains fuse on the rear panel adjacent to the mains input socket. Replace it if necessary only with the spare fuse supplied or with an identical fuse. Repeated failure of the fuse points to a fault that should be investigated by your retailer or Naim itself.

2.3 Non-rewirable Mains Plugs

If a non-rewirable plug is cut from a mains lead (for whatever purpose) the plug **MUST** be disposed of in a way to render it totally useless. Considerable shock hazard exists if the cut-off plug is inserted into a mains outlet.

2.4 Mains Circuits and Cables

A hi-fi system usually shares a mains circuit with other household equipment some of which can cause distortion of the mains waveform. This distortion can in turn lead to mechanical hum from mains transformers. Some Naim transformers are large in size, making them relatively sensitive to such distortion, and it may be necessary to take account of transformer hum when siting your equipment.

Transformer hum is not transmitted through the speakers and has no effect on the performance of the system; however, a separate mains circuit may reduce it. Such a circuit (ideally with a 30 or 45 Amp rating) will also generally improve system performance. Advice on the installation of a separate mains circuit should be sought from a qualified electrician.

Use only the mains leads and plugs supplied or the Naim PowerLine mains cable.

3. General Installation

Naim equipment is designed to offer the finest performance possible avoiding compromise wherever practical. This can lead to circumstances that may be unfamiliar. The notes that follow contain advice specifically related to Naim equipment as well as more general warnings about the use of domestic audio products. Please read them carefully.

3.1 Siting The Equipment

In order to reduce the risk of hum audible from the loudspeakers, power supplies and power amplifiers should be located a reasonable distance away from other equipment. The maximum separation distance for connected equipment is that allowed by the standard interconnect lead.

Some Naim equipment is extremely heavy. Check the weight of the equipment prior to lifting and if necessary use more than one person so that it can be moved safely. Ensure that your equipment rack or table can easily support the weight and is stable.

3.2 Switching On

Source components and power supplies should be switched on before the power amplifiers. Always switch amplifiers off and wait a minute before connecting or disconnecting any leads. Always use the power switch on the product rather than a mains outlet switch.

A “thump” may be heard from the loudspeakers as power amplifiers are switched on. This is normal, will not cause any loudspeaker damage and does not point to any fault or problem. A mild “pop” may also be heard shortly after equipment is switched off.

3.3 Running In

Naim equipment takes a considerable time to run in before it performs at its best. The duration varies, but under some conditions the sound may continue to improve for over a month. Better and more consistent performance will be achieved if the system is left switched on for long periods. It is worth remembering however that equipment left connected to the mains can be damaged by lightning.

3.4 Radio Interference

In some circumstances, depending on where you live and the earthing arrangements in your home, you may experience radio frequency interference. Controls on broadcasting in some territories allow very high levels of radio frequency radiation and both the choice and exact siting of equipment may be critical. Susceptibility to radio frequency interference is related to the wide internal bandwidth necessary for high sound quality. A radio frequency filter kit is available for some Naim equipment but sound quality will be progressively compromised as more elements of the kit are fitted.

3.5 Lightning Precautions

Your Naim hi-fi system can be damaged by lightning and should be turned off and disconnected from the mains when there is risk of lightning strike. For complete protection all mains plugs and any aerial cables should be disconnected when not in use.

3.6 Problems?

Consumer protection varies from country to country. In most territories a retailer must be prepared to take back any equipment he has sold if it cannot be made to work satisfactorily. A problem may be due to a fault in the system or its installation so it is essential to make full use of your dealer’s diagnostic skills. Please contact your local distributor, or Naim Audio directly, if any difficulties cannot be resolved.

Some Naim equipment is made in special versions for different territories and this makes it impracticable to arrange international guarantees. Please establish the local guarantee arrangements with your retailer. Contact Naim Audio directly for help and advice if necessary.

3.7 Service and Updates

It is essential that repairs and updates are only carried out by an authorised Naim retailer or at the factory by Naim itself. Many components are custom made, tested or matched and appropriate replacements are often unobtainable from other sources.

Direct contact to Naim for service or update information should be made initially through Customer Services:

Tel: +44 (0)1722 426600
Email: info@naimaudio.com

Please quote the product serial number (found on its rear panel) in all correspondence.

CD555

4. CD555 Introduction and Installation

The CD555 CD Player can only be operated from a Naim CD 555PS Power Supply. Connection of the power supply is illustrated in Section 5.2. CD player control and operation is described in Sections 16, 17 and 18.

The CD555 should be installed on a dedicated equipment stand intended for the purpose. To improve sound quality the player has hard metallic feet which may blemish any delicate surface on which it is placed. Do not stand the player directly on top of another item of Naim Audio equipment. Care should be taken to ensure that the player is level.

Seven transit screws on the underside of the CD555 case should be removed before use and must be replaced if the unit is to be moved or re-packed and shipped. Transit screw locations are shown, and notes on their removal are provided, below. The transit screws must not be used in any other Naim product. Do not invert the player while removing the transit screws or once the transit screws are removed.

The player and power supply should be installed in their final locations before connecting cables or switching on. Ensure that power amplifiers are switched off and the preamplifier volume is turned down before the power supply is switched on. The power button is located on the front panel.

The player and power supply are heavy and care should be taken when lifting or moving them. Make sure that the surface on which they are to be placed can support their weight.

4.1 Transit Screws

Seven transit screws must be removed from the underside of the CD555 before use and be replaced if the player is to be carried any distance, packed or shipped. The transit screw locations are illustrated in the diagram below. CD555 transit screws must not be used with any other Naim product.

The player must not be inverted either during or after transit screw removal.

To gain access to the transit screws, position one side of the player over the edge of a table, remove (or replace) the screws that become accessible and then repeat as necessary with other sides of the player to access the remaining screws. If the transit screws are to be replaced the three different types must be used in their correct locations.

4.2 Transit Screw Locations

To identify the transit screw types refer to the following table:

Location	Screw Type
A	10mm White
B	25mm Black
C	Stainless Steel

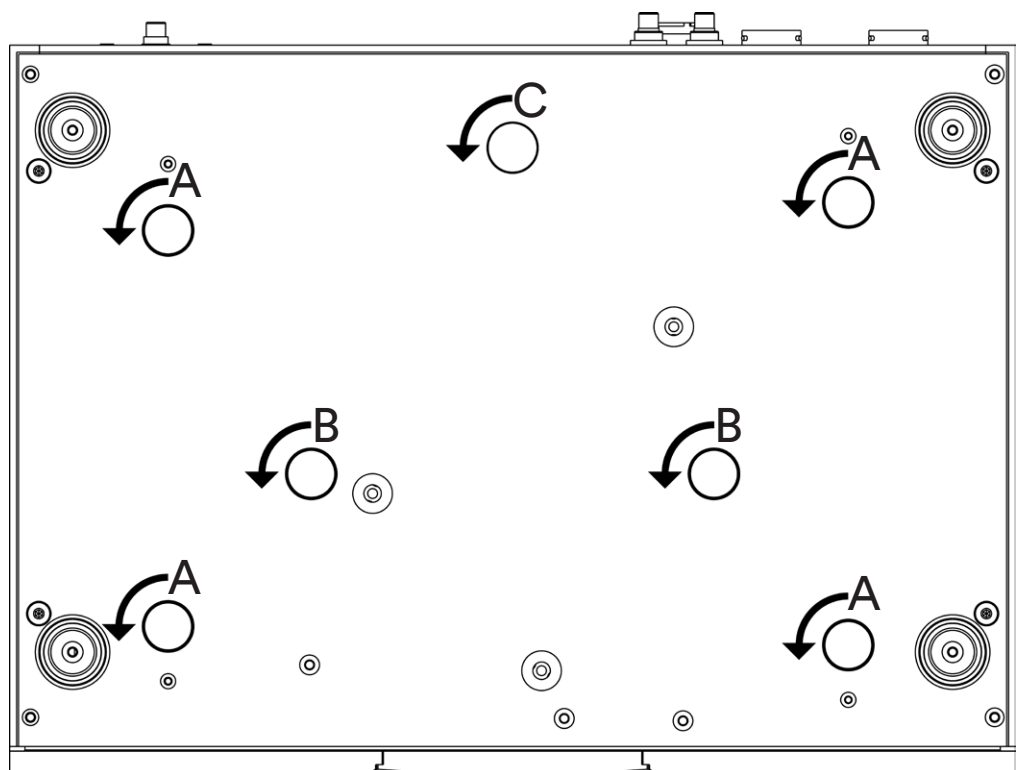

CD555

5. CD555 Connections

5.1 Rear Panel

Note: Icon descriptions can be found in Section 19.

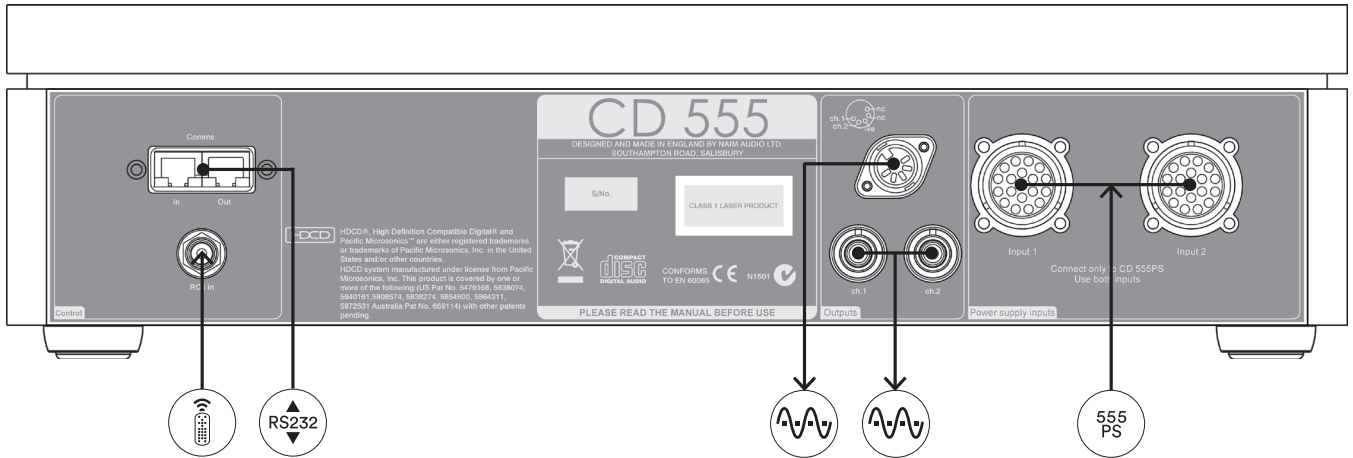

Note: The RC5 Input is intended to accept external control signals for multi-room applications. Contact your dealer or Naim Audio directly for further information.

Note: The optional RJ45 socket Comms Interface can provide external control of the player in custom installations. Contact your dealer or Naim Audio directly for further information.

Note: RCA phono and DIN output sockets should not be connected simultaneously.

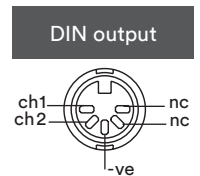

5.2 CD555 Connected to CD 555PS

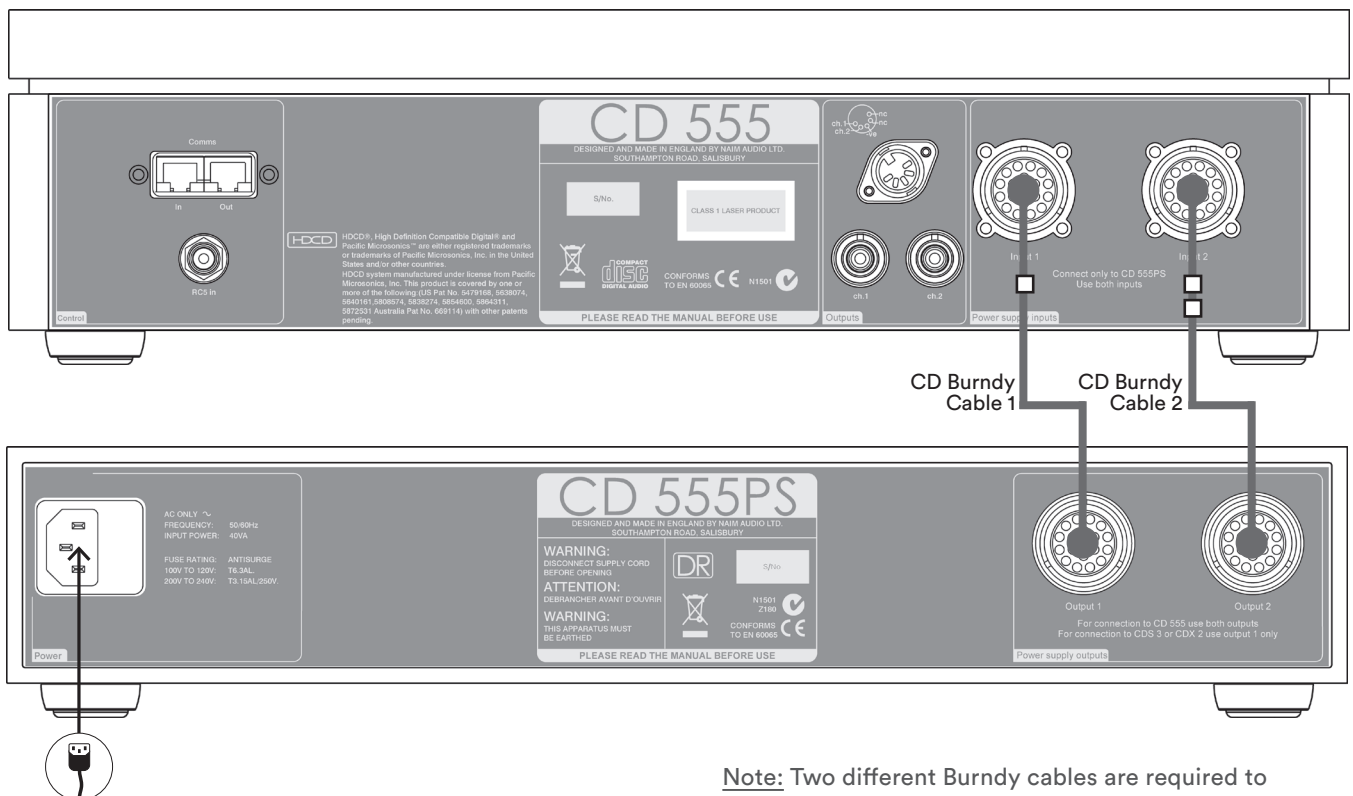

Note: Two different Burndy cables are required to connect the CD555 to the CD 555PS. Cable 1, identified by a single band on its direction marker, should be used with Sockets 1, and Cable 2, identified by a double band on its direction marker, should be used with Sockets 2.

CD555

6. CD555 In Use

6.1 Disc Loading

To open the transport door press the player door button or the handset open key. To load a disc place it on the platter followed by the magnetic puck. Do not use a puck from any other Naim CD player.

If the player is stopped the door will open automatically when a hand is moved towards the proximity sensor located in the player front panel display window.

To close the door press the player door button or the handset open key. The door will also close if the player play button or handset play key are pressed.

Note: If the door hits an obstruction the door indicator will flash and the door will stop moving. Remove the obstruction before attempting to open or close the door again.

Note: If the door is left open for five minutes it will close automatically to prevent inadvertent damage or dust build-up within the player.

Note: If an HDCD® encoded compact disc is loaded the CD555 will automatically recognise and decode it. The display will read HDCD for a few seconds after play is pressed.

6.2 Player Maintenance

It is important for reliable operation of the CD555 to ensure that the surfaces of the transport platter and the underside of the puck are free of dust or debris which can prevent the disc from sitting properly and cause it to slip.

To clean the transport platter, take a piece of Blu-Tack and lightly apply it to the top surface of the hub, picking up any material attached to it. Brush the plastic outer edge lightly with your finger or a soft brush to ensure that it is dust and particle free. Similarly, clean the puck with Blu-Tack, to remove debris from its underside.

Do not, under any circumstances, use any solvents or fluids for the cleaning process.

6.3 Player Door Reset and Calibration

If at any time the player door fails to open or close correctly, or the top panel door button flashes, the door may need re-setting and calibrating. The procedures are as follows.

Note: It may only be necessary to carry out the Position Calibration procedure.

6.3.1 Door Position Calibration

Switch the player off. Hold down the top panel door button and switch the player on. The player display should read - - . Switch the player off and, after a short while, back on again. If the door button flashes this indicates that the Door Reset and Motion Calibration procedures are necessary. Carry out the following two procedures.

6.3.2 Door Reset

Note: Door Reset will also reset DIN/Phono Socket selection, Display settings, RC5/RS232 settings and Control Mode setting (see Section 16.2).

Switch the player off. Hold down the top panel stop button and switch the player on. Switch the player off and carry out the Door Motion Calibration procedure.

6.3.3 Door Motion Calibration

With the door fully closed press and hold the top panel door and play buttons and switch the player on.

The door will continually open and close and the level of open/close gain adjustment will be displayed. Allow the player to run until the values displayed for open and close have settled to consistent values. The door should now open and close consistently. Switch the player off and, after a short while, back on again. The door should now operate correctly.

CDX2

7. CDX2 Introduction and Installation

The CDX2 CD Player can be operated either from its internal power supply or, for improved performance, from an external Naim CD 555PS or XPS Power Supply. Connection of the XPS Power Supply is illustrated in Diagram 11.2. CD player control and operation is described in Sections 16, 17 and 18.

The CDX2 should be installed on a dedicated equipment stand intended for the purpose. To improve sound quality the player has hard metallic feet which may blemish any delicate surface on which it is placed. Do not stand the player directly on top of another item of Naim Audio equipment. Care should be taken to ensure that the player is level.

The CDX2 is fitted with both analogue and S/PDIF digital output options selectable using a rear panel switch.

A transit screw on the underside of the CDX2 should be removed before use and must be replaced if the unit is to be moved or re-packed and shipped. The transit screw must not be used in any other Naim product. Do not invert the player once the transit screw is removed.

The player (and external power supply if used) should be installed in its final location before connecting cables or switching on. Ensure that power amplifiers are switched off and the preamplifier volume is turned down before the player (or external power supply) is switched on. The player power button is located on the rear panel. Power supply power buttons are located on their front panels.

The player and power supply are heavy and care should be taken when lifting or moving them. Make sure that the surface on which they are to be placed can support their weight.

8. CDX2 Connections

8.1 Rear Panel

Note: Icon descriptions can be found in Section 19.

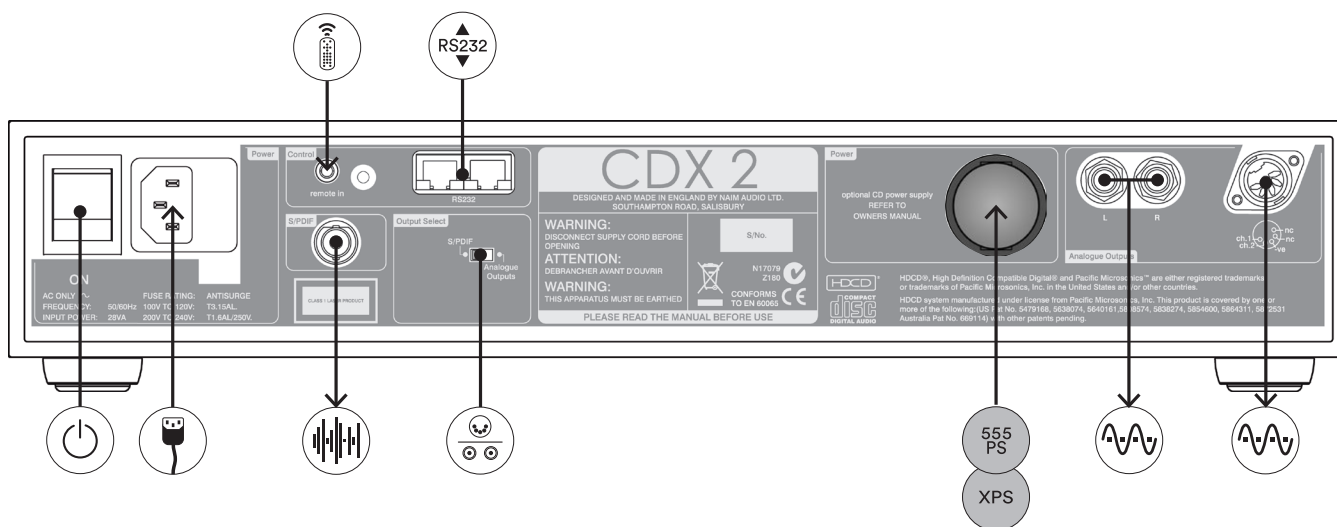

Note: The power supply link plug should be fitted unless an external upgrade power supply is in use.

Note: The Remote Input is intended to accept external control signals for multi-room applications. Contact your dealer or Naim Audio directly for further information.

Note: The optional RS232 Interface can provide external control of the player in custom installations. Contact your dealer or Naim Audio directly for further information.

Note: RCA phono and DIN output sockets should not be connected simultaneously.

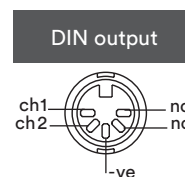

CDX2

8.2 CDX2 Connected to XPS Power Supply

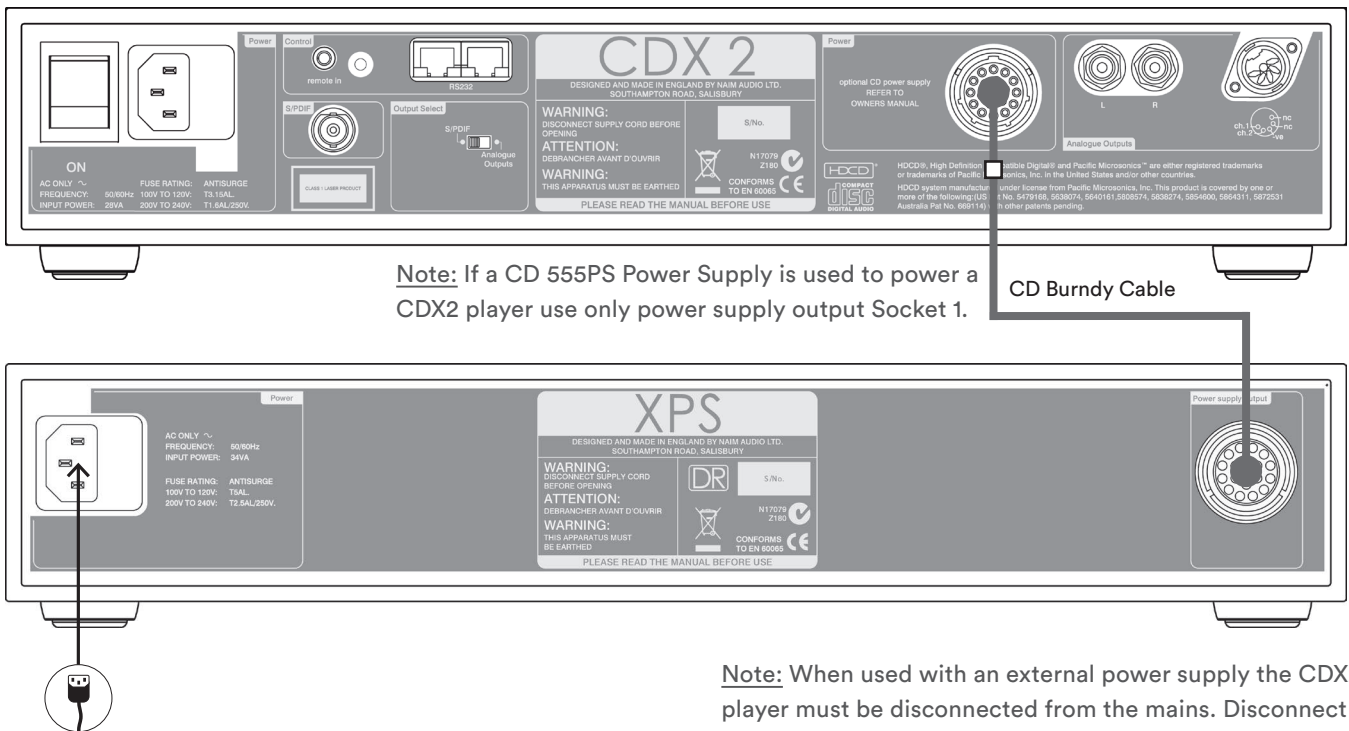

9. CDX2 In Use

9.1 Signal Output Selection

The CDX2 can provide either analogue or S/PDIF format digital signal output. The analogue output is carried by either a single DIN socket or a pair of RCA phono sockets. The digital output is carried by a single 75Ω BNC socket.

Digital and analogue outputs may not be used simultaneously. Selection is achieved by using the rear panel mounted switch. The CDX2 must be switched off before the output selection switch is operated. Ensure the correct cables are connected before switching the CDX2 back on.

Note: Your local retailer will be able to offer advice on digital output cables.

9.2 Disc Loading

To load a compact disc pull open the CD drawer using the handle on the left hand side of the player. Place the disc on the platter followed by the magnetic puck. Do not use a puck from any other Naim CD player. Different Naim CD players use dissimilar pucks.

Note: If an HDCD® encoded compact disc is loaded the CDX2 will automatically recognise and decode it. The display will temporarily read HDCD after play is selected.

9.3 Power Supply Upgrade

The CDX2 can be upgraded by the addition of a CD 555PS, XPS or XP5 XS Power Supply. The external supply takes over from the internal power supply of the CDX2 and offers both a greater number of separate supplies and more sophisticated voltage regulation.

The external supply is connected to the CDX2 via a heavy duty “Burndy” cable. Switch off both the power supply and CDX2 when making connections and remove the CDX2 mains cable. Remove the CDX2 link plug and connect the Burndy cable ensuring that the connectors are securely attached and their twist lock mechanisms are engaged. Switch on the power supply from its front panel power button. After a short while the CDX2 will function as normal.

9.4 Player Maintenance

It is important for reliable operation of the CDX2 to ensure that the surfaces of the transport platter and the underside of the puck are free of dust or debris which can prevent the disc from sitting properly and cause it to slip.

To clean the transport platter, take a piece of Blu-Tack and lightly apply it to the top surface of the magnetic metal hub, picking up any material attached to it. Brush the plastic outer edge lightly with your finger or a soft brush to ensure that it is dust and particle free. Similarly, clean the puck with Blu-Tack, to remove debris from its underside. Do not, under any circumstances, use any solvents or fluids for the cleaning process.

CD5 XS

10. CD5 XS Introduction and Installation

The CD5 XS CD Player can be operated either from its internal power supply only or, for improved performance, with an additional external Naim Flatcap or Hi-Cap power supply. Connection of the power supply is illustrated in Diagram 14.2. CD player control and operation is described in Sections 16, 17 and 18.

The CD5 XS should be installed on a dedicated equipment stand intended for the purpose. Do not stand the player directly on top of another item of Naim Audio equipment. Care should be taken to ensure that the player is level.

The CD5 XS is fitted with both analogue and S/PDIF digital output options selectable using a rear panel switch.

A transit screw on the underside of the CD5 XS case should be removed before use and must be replaced if the unit is to be re-packed and shipped. This transit screw must not be used in any other Naim product. Do not invert the player once the transit screw is removed.

The player (and external power supply if used) should be installed in its final location before connecting cables or switching on. Ensure that power amplifiers are switched off and the preamplifier volume is turned down before the player (or external power supply) is switched on. The player power button is located on the rear panel. The Flatcap power supply power button is located on its rear panel. The Hi-Cap power supply power button is located on its front panel.

11. CD5 XS Connections

11.1 Rear Panel

Note: Icon descriptions can be found in Section 19.

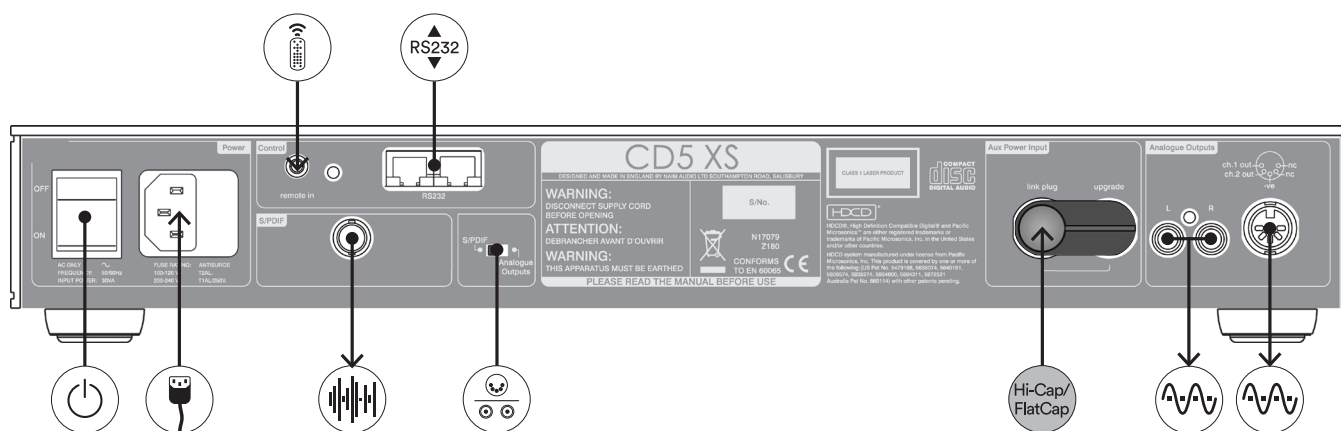

Note: The power supply link plug should be fitted unless an external upgrade power supply is in use.

Note: The Remote input socket is intended to accept external control signals for multi-room applications. Contact your dealer or Naim Audio directly for further information.

Note: The optional RS232 interface can provide external control of the player in custom installations. Contact your dealer or Naim Audio directly for further information.

Note: RCA phono and DIN output sockets should not be connected simultaneously.

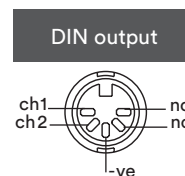

CD5 XS

11.2 CD5 XS Connected to FlatCap XS Power Supply

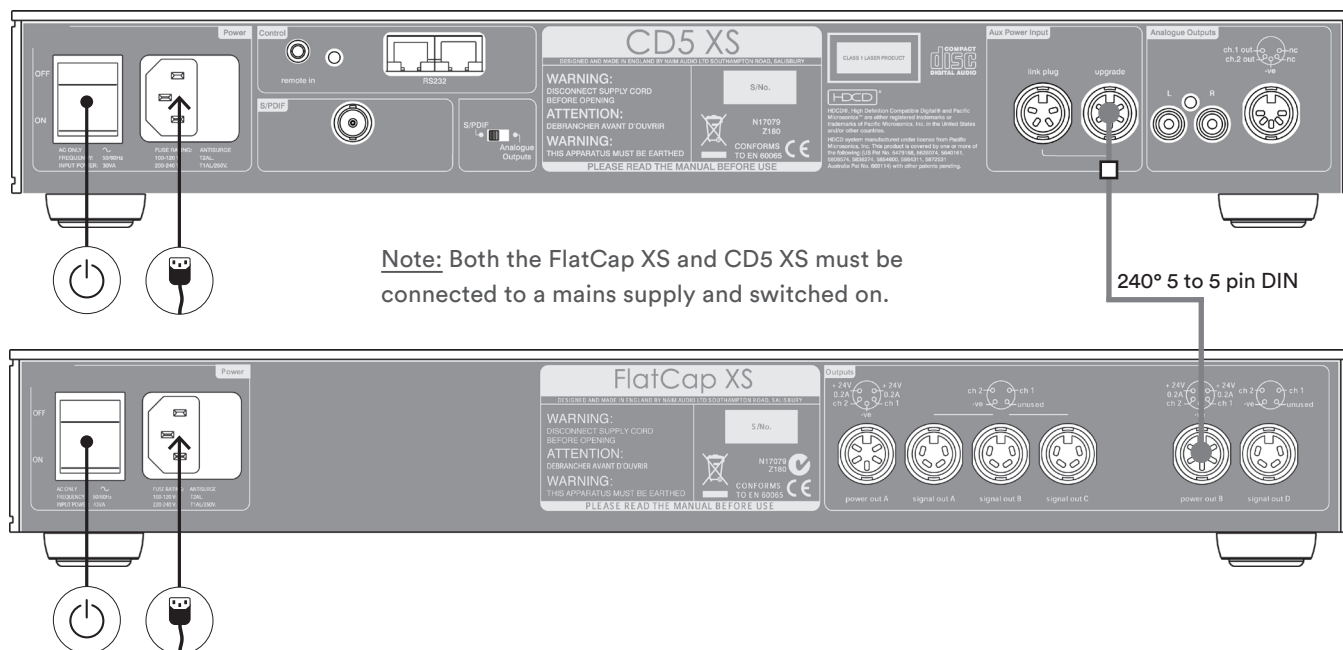

12. CD5 XS In Use

12.1 Signal Output Selection

The CD5 XS can provide either analogue or S/PDIF format digital signal output. The analogue output is carried by either a single DIN socket or a pair of RCA phono sockets. The digital output is carried by a single 75Ω BNC socket.

Digital and analogue outputs may not be used simultaneously. Selection is achieved by using the rear panel mounted switch. The CD5 XS must be switched off before the output selection switch is operated. Ensure the correct cables are connected before switching the CD5 XS back on.

Note: Your local retailer will be able to offer advice on digital output cables.

12.2 Disc Loading

To load a compact disc pull open the CD drawer using the handle on the left hand side of the player. Place the disc on the platter followed by the magnetic puck. Do not use a puck from any other Naim CD player. Different Naim CD players use dissimilar pucks.

Note: If an HDCD[®] encoded compact disc is loaded the CD5 XS will automatically recognise and decode it. The display will read HDCD for a few seconds after play is pressed.

12.3 Power Supply Upgrade

The CD5 XS analogue output stage can be upgraded through the addition of an external Flatcap or Hi-Cap Power Supply. The external supply works with the internal power supply of the CD5 XS to offer both a greater number of separate supplies and more sophisticated voltage regulation. The Power Supply is connected to the CD5 XS via a five pin DIN cable. Switch off both the power supply and CD5 XS when making connections. Remove the link plug and connect the supply cable ensuring that the connectors are securely attached. Switch on both the CD5 XS and the power supply from their respective power buttons.

12.4 Player Maintenance

It is important for reliable operation of the CD5 XS to ensure that the surfaces of the transport platter and the underside of the puck are free of dust or debris which can prevent the disc from sitting properly and cause it to slip. To clean the transport platter, take a piece of Blu-Tack and lightly apply it to the top surface of the magnetic metal hub, picking up any material attached to it. Brush the plastic outer edge lightly with your finger or a soft brush to ensure that it is dust and particle free. Similarly, clean the puck with Blu-Tack, to remove debris from its underside.

Do not, under any circumstances, use any solvents or fluids for the cleaning process.

CD5si

13. CD5si Introduction and Installation

The CD5si should be installed on a dedicated equipment stand intended for the purpose. Do not stand the player directly on top of another item of Naim Audio equipment. Care should be taken to ensure that the player is level.

A transit screw on the underside of the CD5si case should be removed before use and must be replaced if the unit is to be re-packed and shipped. This transit screw must not be used in any other Naim product. Do not invert the player once the transit screw is removed.

CD player control and operation is described in Sections 16, 17 and 18.

14. CD5si Connections

14.1 Rear Panel

Note: Icon descriptions can be found in Section 19.



Note: RCA phono and DIN output sockets should not be connected simultaneously.

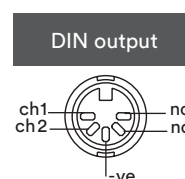

15. CD5si In Use

15.1 Disc Loading

To load a compact disc pull open the CD drawer using the handle on the left hand side of the player. Place the disc on the platter followed by the magnetic puck. Do not use a puck from any other Naim CD player. Different Naim CD players use dissimilar pucks.

15.2 Player Maintenance

It is important for reliable operation of the CD5si to ensure that the surfaces of the transport platter and the underside of the puck are free of dust or debris which can prevent the disc from sitting properly and cause it to slip.

To clean the transport platter, take a piece of Blu-Tack and lightly apply it to the top surface of the magnetic metal hub, picking up any material attached to it. Brush the plastic outer edge lightly with your finger or a soft brush to ensure that it is dust and particle free. Similarly, clean the puck with Blu-Tack, to remove debris from its underside.

Do not, under any circumstances, use any solvents or fluids for the cleaning process.

16. CD Player Control and Operation

The operation and control of all Naim CD players is based on a common user interface. This section of the manual describes the user interface, drawing attention to differences between players where they occur.

The CD player control buttons are duplicated on the remote control handset which may also provide some extra functions. The handset also provides CD programming facilities. See Sections 17 and 18 for more information.

16.1 Player Controls

door: Opens and closes the door (CD555 only).

disp: Scrolls through the display options of track, time and display off (CD555 only).

Note: The CDX2, CD5 XS and CD5si display options can be scrolled by pressing the remote handset disp key.

prev: Steps through the disc backwards, either one track at a time, or sequentially if the button is held.

next: Operates in the same way as the prev button, but moving forwards instead of backwards.

pause: Pauses play. Pressing pause a second time will resume play. The pause button indicator will flash when pause is selected (CD555 only).

Note: The CDX2, CD5 XS and CD5si can be paused by pressing the remote handset pause key.

Note: If a player is paused for more than 10 minutes it will enter a “static pause” mode in which the transport deactivates to reduce wear. The player can be left in static pause mode indefinitely. The pause button indicator will illuminate fully when the player is in static pause mode.

stop: Stops play and resets the player to its start condition. Pressing and holding stop will clear any programmed play order, or, if no play order is programmed, return the player display to its defaults.

play: Plays a disc from track one unless another track has been selected. Pressing play while a track is playing will re-start the track.

16.2 Player Control Modes

CD players have an optional control mode. This provides an alternative interface in which fast forward and fast reverse (rather than step forwards and step backwards) can be selected by pressing and holding the CD player next and prev buttons respectively. The alternative interface also provides a pause function on CDX2, CD5 XS and CD5si players selected by pressing and holding the play button. To select the optional mode press and hold next while the player switches on. To select the standard control mode press and hold prev while the player switches on.

16.3 Player Display and Indicators

The alphanumeric display indicates track and index numbers, time in minutes and seconds, or system messages. If a play list is programmed the time displayed reflects the duration of the programme. Depending on the model in question, some or all of the indicators described below will be found adjacent to the display:

HDCD: Indicates that an HDCD encoded disc is playing.

Note: HDCD decoding is not implemented in the CD5si.

repeat: Indicates that repeat has been selected from the remote handset.

prog: Indicates that a play list has been programmed.

track: Indicates display of number of tracks or current track.

pause: Indicates that the player is paused.

stop: Indicates that the player is stopped.





play: Indicates that the player is playing.

time: Indicates display of disc time or track time.

16.4 Output Socket Selection

A pair of RCA Phono output sockets are fitted on CD player rear panels to provide an alternative to the preferred DIN socket. Proceed as follows to select the RCA Phono sockets.

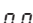
With the player stopped, press and hold the remote handset disp function (handset in CD mode) or, if fitted, the player disp button until the CD player prog indicator flashes. Further operations of the disp function will now cycle through each combination of the two socket types (DIN only, RCA Phono only or both). The selected option is indicated on the CD player display as shown below.

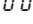
<u>Socket Option</u>	<u>Player Display</u>
DIN	
Phono	 
Both	 

Press and hold the disp function a second time to exit from socket selection mode.

To avoid compromised sound quality, do not select both unless their simultaneous use is unavoidable.

17. R-com Remote Handset

The R-com remote handset is supplied with the NAC 552 and CD555 and can be purchased as an accessory. It offers quick and intuitive control of the most often used functions of CD players, preamplifiers, integrated amplifiers and tuners.

To fit batteries, remove the bottom end cover using the tool provided and insert the batteries into the body taking care with their orientation. Replace the end cover. Remove the batteries if the R-com is to be packed and shipped.

17.1 Using R-com

R-com keys primarily provide control of the functions most often used on CD players, preamplifiers, integrated amplifiers and tuners. In order to extend battery life, R-com will enter a 'sleep' mode when unused. It will 'wake' on being touched.

R-com has three operational modes - CD Player mode, Preamplifier/Integrated amplifier mode and Tuner mode. Its default mode is CD player. When awake in CD Player mode, all R-com keys will illuminate green. To switch the R-com into Preamplifier/Integrated amplifier mode or Tuner mode press the pre or tun keys respectively. The pre or tun key will then illuminate white. To switch R-com back into CD player mode either press the pre or tun key again.

In default mode the R-com keys have the following functions:

- disp: Scrolls through the display options of track, time and display off.
- open: Opens the door on the CD555.
- stop: Stops CD replay.
- play: Begins CD replay.
- prev: Selects the previous track or index point.
- next: Selects the next track or index point.
- vol +: Increases the preamplifier/integrated amplifier volume.
- vol -: Decreases the preamplifier/integrated amplifier volume.
- mute: Reduces the volume to zero. A second press restores the volume.
- pause: Pauses CD replay. A second press restores play.

In Preamplifier/Integrated amplifier mode (press pre key), the following keys change function:

- disp: Switches the preamplifier/integrated amplifier front panel button indicators and knob indicators off and on.
- prev: Selects the previous source input.
- next: Selects the next source input.

Note: Preamplifier or integrated amplifier program mode can be selected from the R-com by pressing and holding the pre key. Program mode functions can then be accessed from the equipment front panel.

In Tuner mode (press tun key) the following keys will change function:

- disp: Switches the tuner display and front panel button indicators off and on.
- prev: Selects the tuner "down" function.
- next: Selects the tuner "up" function.

Note: Tuner modes can be selected from the R-com by an extended press of the tun key.

17.2 R-com Keys

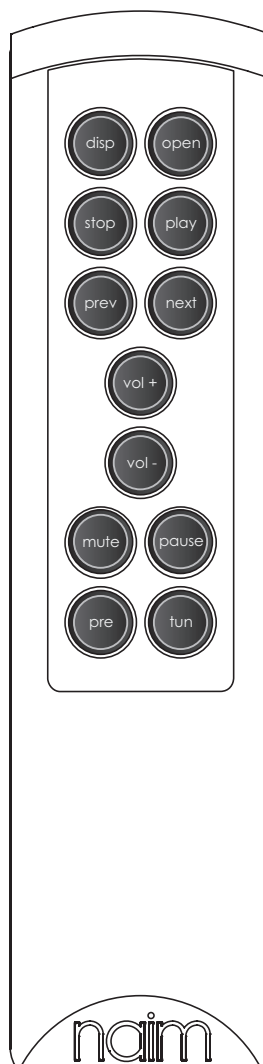

18. NARCOM 5 Remote Handset

The NARCOM 5 is a multifunctional remote handset designed specifically for Naim CD players, analogue tuners and preamplifiers (including integrated amplifiers). To fit batteries, remove the battery cover and insert the batteries into the body taking care with their orientation. Replace the battery cover.

18.1 Using NARCOM 5

NARCOM 5 can be configured to operate preamplifiers, tuners or CD players by pressing the appropriate System Component Key.

Note: The 'rec' system component key enables record side input, mute and mono selection on appropriately equipped preamplifiers.

NARCOM 5 keys behave as described below:

- disp:** Selects illumination options.
- numeric:** Selects preamplifier inputs, CD tracks or tuner presets or frequencies.
- ↻:** Repeats a CD or CD playlist.
- prog:** Press and hold to select preamplifier program mode. Enables CD playlist programming and tuner preset management.
- vol (- / +):** Adjusts volume and volume control position.
- mute:** Mutes and restores volume.
- bal (- / +):** Adjusts channel balance.
- mon:** Enables a record device output to be heard while recording. Alternatively, selects mono mode on some products.
- ▶|||◀▶|◻:** CD play, pause, previous, next and stop.
- ◀◀▶▶:** CD fast reverse and forward. The keys can also select preamplifier inputs and FM radio frequencies.
- mode:** Selects FM frequency, scan and preset modes.
- scan:** Selects tuner scan mode. When a station is found the scan will pause. A second press will resume the scan.

18.2 NARCOM 5 keys

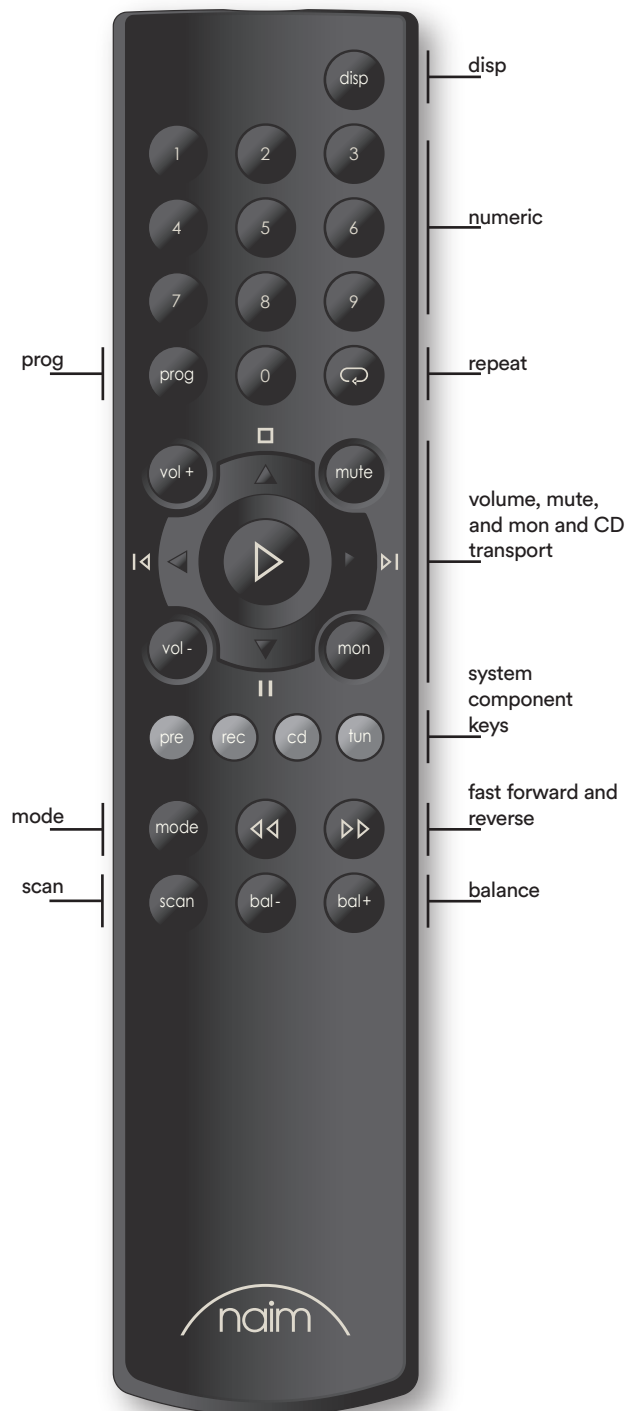

19. Diagram Icons



Power switch



Analogue signal



Digital signal



DIN/Phono socket selection switch



555PS Power Supply



Optional 555PS Power Supply



Optional XPS Power Supply



Optional FlatCap or Hi-CapPower Supply



RS232 Interface



RC5 remote control signal



IEC mains supply



180° DIN 5-pin



Cable direction indicator

20. Puck Identification

Three different pucks are used to clamp CDs in the players covered by this manual (CD555, CDX2, CD5 XS and CD5si). Only the appropriate puck will work correctly in each player. The three pucks are illustrated below and their player applications listed.

20.1 CD555

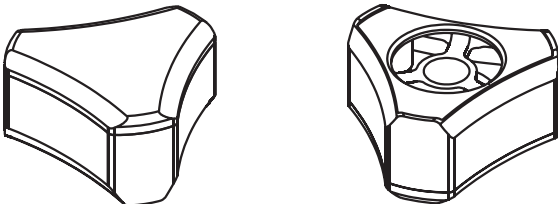

20.2 CDX2, CD5 XS

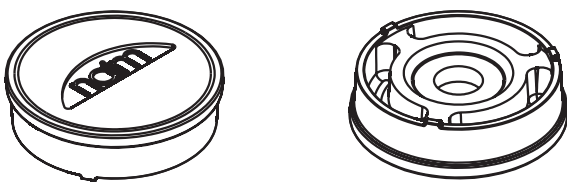

20.3 CD5si

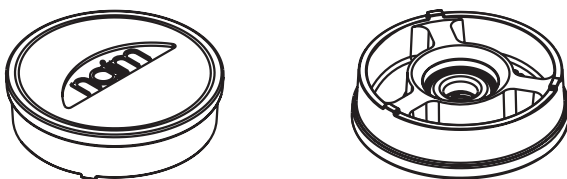

21. Declarations of Conformity

Declaration of Conformity

Naim Audio declares that Naim Audio products are in conformance with:

Low Voltage Directive 2006/95/EC

Electromagnetic Compatibility Directive 2004/108/EC

Restriction of Hazardous Substances (RoHS2) Directive 2011/65/EU

Waste of Electrical and Electronic Equipment Directive 2012/19/EC

Energy Using Product Directive 2009/125/EC

Naim Audio products comply with the following standards:

EN60065 - Audio, video and similar electronic apparatus - Safety requirements

EN55013 - Sound and television broadcast receivers and associated equipment - Radio disturbance characteristics

EN55020 - Sound and television broadcast receivers and associated equipment - Immunity characteristics

EN61000-3-2 - Mains harmonics current emissions

EN61000-3-3 - Mains flicker emissions

Products that display the crossed-out wheeled bin logo cannot be disposed of as domestic waste. These products must be disposed of at facilities capable of re-cycling them and appropriately handling any waste by-products. Contact your local authority for details of the nearest such facility. Appropriate recycling and waste disposal helps conserve resources and protects the environment from contamination.



22. Statutory Safety Warnings

In order to comply with current European safety regulations it is essential that the Naim loudspeaker connectors supplied with amplifiers and loudspeakers are used.

Do not under any circumstances allow anyone to modify your Naim equipment without first checking with the factory, your retailer, or your distributor. Unauthorised modifications will invalidate your guarantee.

Equipment must not be exposed to dripping or splashing and no objects filled with liquid, such as vases, should be placed on the equipment.

For your own safety do not under any circumstances open Naim equipment without first disconnecting it from the mains.

Warning: an apparatus with CLASS I construction shall be connected to a mains socket outlet with a protective earthing connection.

Warning: batteries installed shall not be exposed to excessive heat such as sunshine, fire or the like.

Where the mains plug or an appliance coupler is used as the disconnect device, the disconnect device shall remain readily operable. To disconnect the equipment from the mains remove the mains plug from the mains outlet.

The following label is attached to all mains powered equipment:



This equipment has been tested and found to comply with the relevant EMC and Safety Standards, and, where applicable, also complies with the limits for a class B digital device, pursuant to Part 15 of the FCC Rules.

These limits are designed to provide reasonable protection against harmful interference in a residential installation. This equipment generates, uses and can radiate radio frequency and, if not installed and used in accordance with the instructions, may cause harmful interference to radio communications. However, there is no guarantee that interference will not occur in a particular installation. If this equipment does cause harmful interference to radio or television reception, which can be determined by turning off and on, the user is encouraged to try to correct the interference by one or more of the following measures:

- Reorient or relocate the receiving antenna.
- Increase the separation between the equipment and the receiver.
- Connect the equipment into an outlet on a circuit different from that to which the receiver is connected.
- Consult your Naim retailer or an experienced radio/TV technician for help.

To the fullest extent permitted by applicable law, Naim Audio Ltd. disclaims all liability for any loss or damages whether real, incidental or consequential that arise from using this product. Naim Audio Limited, its agents and representatives, cannot be held responsible for the loss of any data or content from a Naim/NaimNet server, however caused.

Go Deeper



Naim Audio Ltd. Southampton Road, Salisbury, England SP1 2LN
Call. +44 (0) 1722 426600 Email. info@naimaudio.com
naimaudio.com