

PHILIPS

Micro MusicSystem

6000 Series

TAM6805

Quick Start Guide



Register your product and get support at www.philips.com/support

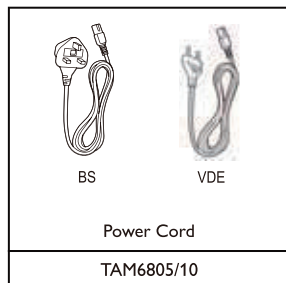
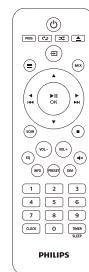

Power Cord
TAM6805/10

1

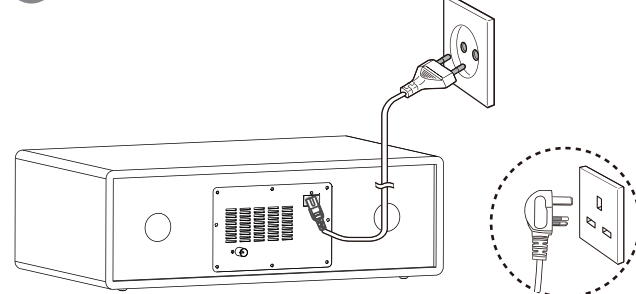

2

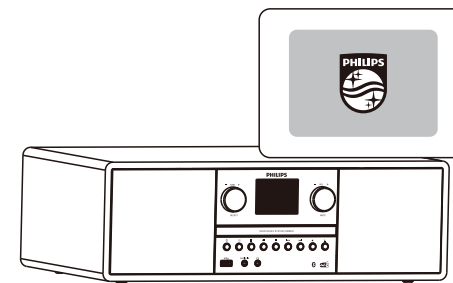
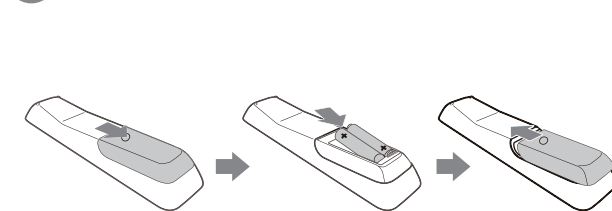

3

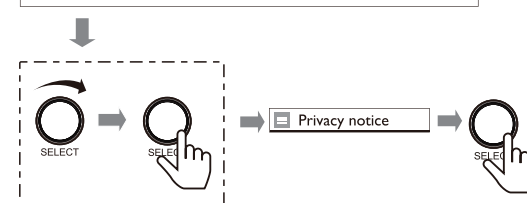
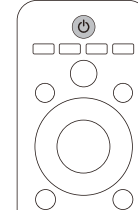

2021 © MMD Hong Kong Holding Limited. All rights reserved. Specifications are subject to change without notice. Philips and the Philips Shield Emblem are registered trademarks of Koninklijke Philips N.V. and are used under license. This product has been manufactured by and is sold under the responsibility of MMD Hong Kong Holding Limited or one of its affiliates, and MMD Hong Kong Holding Limited is the warrantor in relation to this product.

TAM6805_10_QSG_V2.0

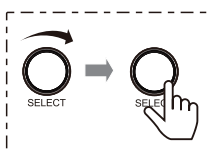

1

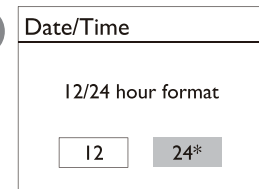

2

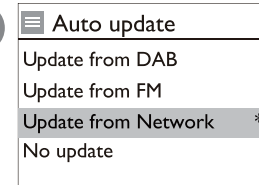

3

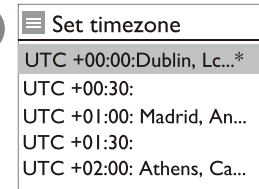

4



5

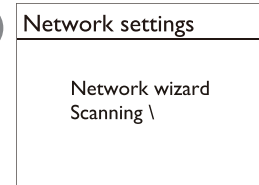

6

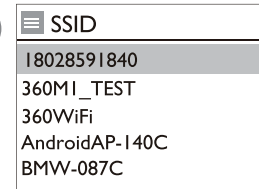

7

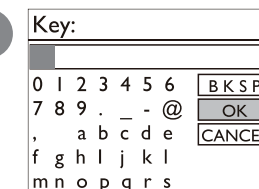

8

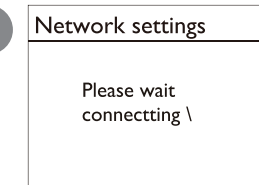

9

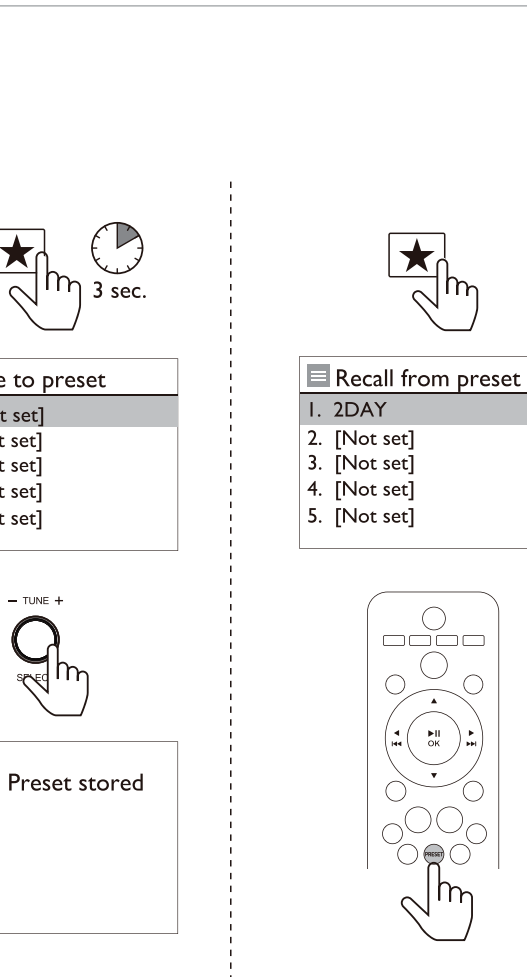
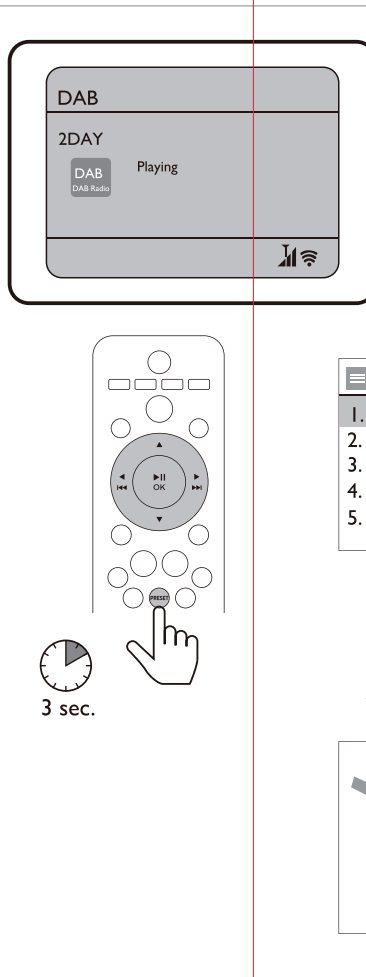
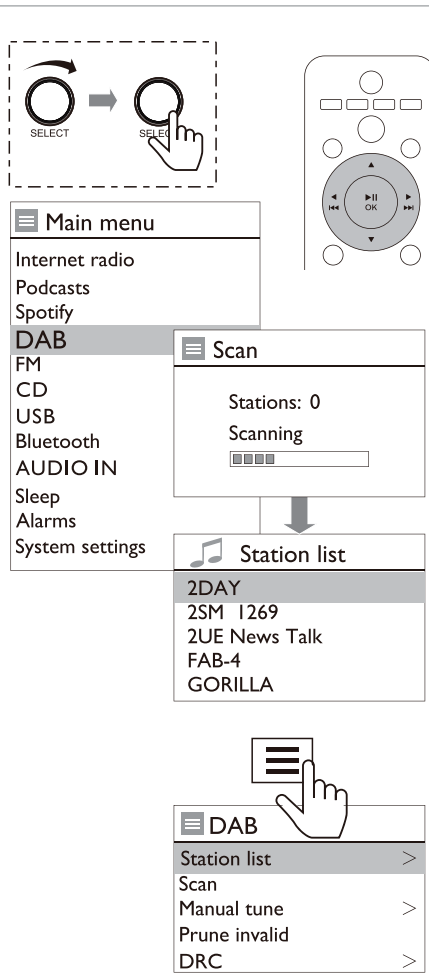
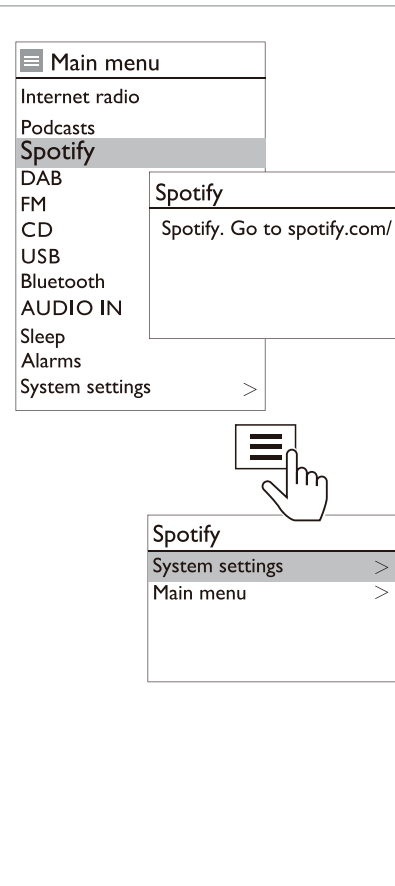
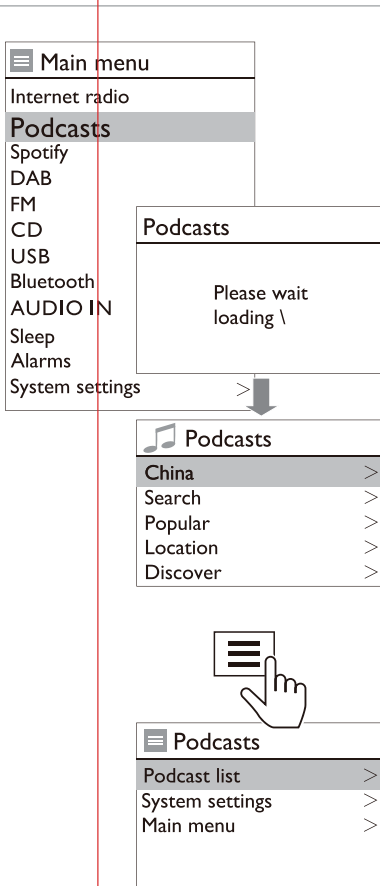
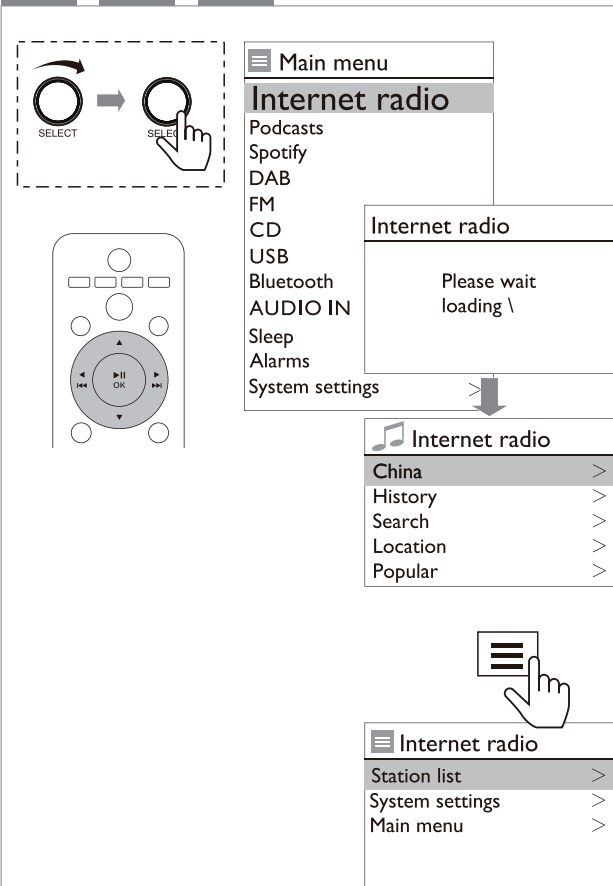
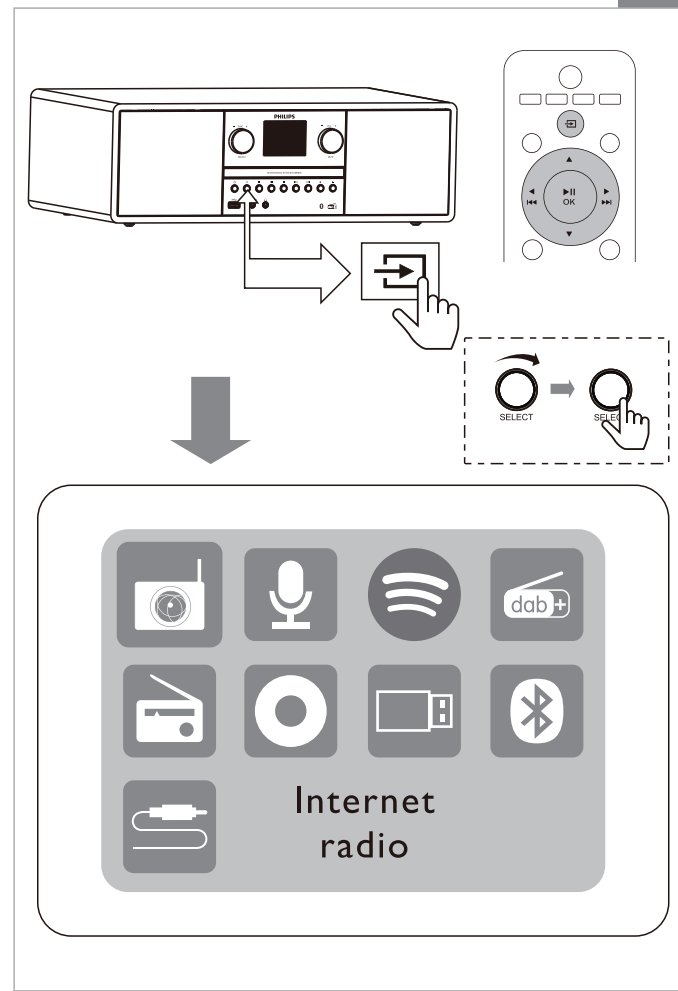

The diagram illustrates the steps to play a CD on the device:

- 1** Press the **CD** button on the remote control.
- 2** Press the **SELECT** button on the touch screen.
- 3** Press the **SELECT** button on the touch screen (indicated by a hand icon).
- 4** Press the **SELECT** button on the touch screen (indicated by a hand icon).

The touch screen displays the **CD** menu, showing **No disc** and a **CD** icon. The remote control shows the **CD** button highlighted.

The diagram illustrates the steps to connect a USB device to the car stereo:

- Step 1:** Press the **SELECT** button on the remote control.
- Step 2:** Press the **SELECT** button on the car stereo's control panel.
- Step 3:** The car stereo displays **USB** and **No Usb** on its screen.
- Step 4:** A USB device is connected to the car stereo's USB port.

The diagram illustrates the process of connecting a smartphone to a car stereo using an auxiliary cable. It is divided into two numbered steps:

- Step 1:** The car stereo's display shows the 'Main menu' with options: Internet radio, Podcasts, Spotify, DAB, FM, CD, USB, Bluetooth, and **AUDIO IN** (highlighted). A hand icon points to the 'AUDIO IN' option.
- Step 2:** The car stereo's display shows the 'Auxiliary Input' screen with 'AUDIO IN' and a car stereo icon. A hand icon points to the 'AUDIO IN' port on the front of the car stereo. An auxiliary cable is shown connecting the car stereo's 'AUDIO IN' port to the smartphone's headphone jack.

The diagram illustrates the connection of a smartphone to a portable music player. It is divided into two steps:

- Step 1:** A smartphone and a USB cable are shown separately.
- Step 2:** The USB cable is plugged into the USB port of the portable music player. The other end of the cable is connected to the smartphone, which is shown with a lightning bolt icon on its screen, indicating it is powered on or charging.

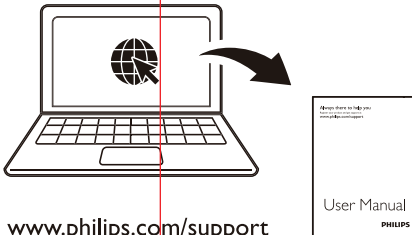

www.philips.com/support

EN To download the full user manual, visit www.Philips.com/support.

CS Uplný návod k použití si můžete stáhnout na adrese www.Philips.com/support.

DA For at downloade hele brugervejledningen, besøg www.Philips.com/support.

DE Besuchen Sie zum Herunterladen der vollständigen Bedienungsanleitung www.Philips.com/support.

EL Για να κατεβάσετε το πλήρες εγχειρίδιο χρήσης, μεταβείτε στη διεύθυνση www.Philips.com/support.

ES Para descargar el manual del usuario completo, visite www.Philips.com/support.

FI Táyden käyttöoppaan voit ladata osoitteesta www.Philips.com/support.

FR Pour télécharger le mode d'emploi complet, visitez www.philips.com/support.

HU A teljes felhasználói kézikönyv letöltéséhez látogasson el a www.Philips.com/support címre.

IT Per scaricare il manuale utente completo, visitare il sito www.Philips.com/support.

KK Толук пайдаланушы нускалуыгын жүктөп алу үшүн мына бетке кириңиз: www.Philips.com/support.

NL Ga naar www.Philips.com/support om de volledige gebruikershandleiding te downloaden.

NO Du kan laste ned en fullstendig brukerhåndbok fra www.Philips.com/support.

PL Aby pobrać kompletną instrukcję obsługi, odwiedź stronę www.Philips.com/support.

PT Para transferir o manual do utilizador completo, visite www.Philips.com/support.

RU Чтобы загрузить полную версию руководства пользователя, перейдите на веб-страницу www.Philips.com/support.

RO Pentru a descărca manualul complet al utilizatorului, accesați www.Philips.com/support.

SK Úplnú používateľskú príručku si môžete prebrať na adrese www.Philips.com/support.

SV Gå till www.Philips.com/support för att ladda ner hela bruksanvisningen.

TR Kullanıcı kılavuzunu indirmek için www.Philips.com/support adresini ziyaret edin.

UK Щоб завантажити повний посібник користувача, відвідайте www.Philips.com/support.

AR لتحميل دليل المستخدم الكامل، يمكنك زيارة الموقع الإلكتروني التالي www.Philips.com/support.

LT Jei norite atsisiųsti visą naudotojų vadovą, apsilankykite www.Philips.com/support.

LV Lai lejupielādētu pilnu lietotāja rokasgrāmatu, apmeklējiet vietni: www.Philips.com/support.

ET Terve kasutusjuhendi allalaadimiseks külastage www.Philips.com/support.

SL Za prenos celotnega uporabniškega priročnika obiščite www.philips.com/support.

HR Da biste preuzeli cijeli korisnički priručnik, idite na www.Philips.com/support.

BR Da biste preuzeli kompletan korisnički priručnik, posetite www.Philips.com/support.

SQ Za preuzimanje kompletnog uputstva za upotrebu, posjetite www.Philips.com/support.

ME Për të shkarkuar manualin e plotë të përdorimit, vizitoni www.Philips.com/support.

BG Да го преземете целостното корисничко упатство, посетете www.Philips.com/support.